



Cleveland Surveying News

October 2007

On September 20th the Cuyahoga Valley National Recreation Area Railroad ran the old Ohio Central steam locomotive 1293 from the Rockside Road station down to Akron.

Photos by Bob Hoy



Newsletter of the Cleveland Chapter of the Professional Land Surveyors of Ohio

Cleveland Surveying News

Circulation: 175 issues

John G. Hoy, P.S. Editor
Robert G. Hoy, P.S. Photographer

MAILING ADDRESS:



Cleveland

Chapter of PLSO

P. O. Box 81713
Cleveland, OH. 44181-0713

2007 Newsletter Advertising Rates:

One-sixth page: 3"h x 3.6"w \$80 yr.
One-half page: 4.5"h x 7.5w \$200 yr.
Full page: \$400 yr.
Single Issue Full Page: \$100
(accepting only two per issue)

Help Wanted or Position Wanted up to one-half page is \$30.00 per issue.

Contact John G. Hoy jhoy.7419@att.net

ADVERTISERS INDEX

3 [Aerocon Photogrammetry](#)
4 [Avatech Solutions](#)
6 Jake's Stakes
10 [Imaginit Technologies](#)
12 [Roberts Surveying Supplies](#)
14 [City Blueprint of Toledo](#)

Contents

Newsletter Information	2
Communication Committee, John G. Hoy	3
Seminar Meeting Registration, Lou Veverka	5
Message from our President, John Bischof	6
September Meeting Review, Joseph F. O'Donnell, Jr.	7
Random Lines, John E. Dailey, Past	8
Seminar Speaker Information	9
Executive Committee Meeting, Robert G. Hoy	10
Education Committee, Tom Snezek Field Technician Seminar Registration	13
Chapter Delegate's Report, Sean Boland	15
2008 Conference Report, Mark Yeager	17
Calendar	17
Delegate Enclosure - COPS proposal	18
Delegate Enclosure - Scholarship Policy	19
Membership Committee, Tim Feller - No Report	

2007 Executive Committee

President

John J. Bischof
Bischof@cvelimited.com
(440) 439-1999

President Elect

Peter D. Zwick
Zwick@eng.ohiocoxmail.com
(440) 235-2729

Past President

Joseph F. O'Donnell, Jr.
Joe.O'donnell@lakewoodoh.net
(216) 529-6809

Treasurer

David J. Bruckner
dbruckner@city.cleveland.oh.us
(216) 664-2462

Secretary

Robert G. Hoy
k666@cox.net

Chapter Delegate

Sean A. Boland
Saboland@gmail.com
(440) 835-5632

Communication

John G. Hoy
Jhoy.7419@att.net
(216) 476-3600

Education

Tom Snezek
dadsurv@aol.com
(216) 671-4902

Program

Louise Veverka
Lvsurvey@sbcglobal.net
(216) 251-6972

Membership

Timothy Feller
timf@mcsteen.com
(440) 585-9800

It's a SAD situation but someone has to talk about it.



John G. Hoy
Communication Trustee
CSN Editor

The leaves on the trees outside my window are starting to show color. What a strange season we've had this year. A very dry spring caused the maple in my yard to refuse to seed. The summer couldn't make up its mind as to whether it would be very dry or horribly wet. The colors are a little early this year. Today is September 21, 2007 and the first day of autumn is on the 23rd. The question that comes to my mind is "Where is the Cuyahoga County GIS?" I'm sure to offend someone at the County Engineer's Office and the County Auditor's Office and the County Recorder's Office but the question must be asked. Last year we were told, "Soon, it should be up by the end of the year", but nothing happened. At the end of last year we were told, "Summer of 2007." Well, summer has come and gone. It's just sad to be in Cuyahoga County.

Cuyahoga County started work on their GIS in 1982. I should know, I worked for the Engineer then and was introduced to the "State of the art CAD system" in January of 1983. At the time Cuyahoga County was the first county in Ohio working on such a project. Twenty-Five years later they aren't finished and now they're one of the last counties in Northeast Ohio still promising a GIS. That's sad too, but the story doesn't end yet. Apparently, according to their web site, the seamless taxmap is finished and the aerial photography overlay is completed. Now they're verifying, verifying, verifying that it looks right. Why? The finished product will have a disclaimer that it's just a representation and shouldn't be used for any detailed location data. All county GIS systems do! They should make the GIS available to the public. The verifying should be part of the ongoing maintenance. On May 4, 2006, representatives

Continued on Page 9....



Aerocon Photogrammetric Services Inc
Dedicated to providing quality photogrammetric services since 1967

- **Aerial Photography**
- **Digital Orthophotography**
- **Digital Topographic Mapping**
- **Analytical Triangulation**
- **DTM/DEM Surface Generation**
- **LiDAR**
- **Airborne GPS**
- **GIS Services**
- **Volumetric Inventories**

4515 Glenbrook Road
Willoughby, OH 44094-8215
440.946.6277
440.946.2646 Fax
e-mail: skymap@aerocon.com
www.aerocon.com





Autodesk Technology. Avatech Expertise.

Better Results.



- Consulting
- Implementation
- Surveying Technologies
- Training and Technical Support
- Software and Custom Development

Technology for the World You Build

- Increase production without additional staff
- Reduce cost, rework, redundancies, and errors
- Proven results to increase your bottom line

What can our solutions do for you?

Call our Cleveland office at **877-717-5600** to find out more.

Leica
Geosystems



AVATECH
SOLUTIONS®

Altogether Smarter Design.

Autodesk

Authorized Value Added Reseller

www.avatech.com

REGISTRATIONS ARE REQUIRED IN ADVANCE

To Register for the next meeting on Thursday, Oct. 4, 2007 contact:

Louise Veverka at (216) 251-6972

**Deadline for Registration is
Monday, October 1, 2007**



Louise Veverka
Program Trustee

**EARN ONE PDH OF CONTINUING PROFESSIONAL
DEVELOPMENT AT EACH MEETING**

Up to 15 PDH's can be carried over to next year.

To join P.L.S.O. and qualify for the discount, download the form from www.ohiosurveyor.org/join.html. If you have any questions about joining contact Barb Jones at (614) 761-2313.

Dinner menu for September 6, 2007:

- Marriott House Salad
- Sliced Roast Sirloin with Mushroom Cabernet Sauce
- Redskin Mashed Potatoes, Broccoli - Cauliflower & Carrots,
- Baked Rolls and butter
- Coffee, Decaf Coffee, Tea, Herbal Tea, Iced Tea or milk
- German Chocolate Cake

Social time in the lounge at 5:30 p.m., Dinner/Meeting at 6:00 p.m.



Cleveland Airport Marriott Hotel
4277 West 150th Street
Cleveland

FREE PARKING

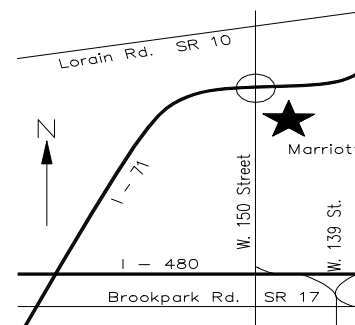

SEMINAR MEETING REGISTRATION

- Oct. 4** **The 1, 2, 3's of Creating Effective Libraries**
- Nov. 1** **Every Good Design Begins with a Solid Foundation**

Cost for each Seminar: **PLSO Members \$35.00 Non-Members \$60.00**

Amount Enclosed: \$ _____

Name _____ Phone Number _____

Email _____ Address _____

Company _____ PLSO Member ? Yes No*

Make checks payable to: **Cleveland Chapter of PLSO**
P.O. Box 81713
Cleveland, OH. 44181

Registration is required in advance.

* to join PLSO and qualify for the discount, apply without delay at www.ohiosurveyor.org/join.html

Dear Members,

Summer has officially ended and our CPD sessions are in full swing. There are still two more scheduled seminars being held on October 4th and November 1st, 2007. You can still earn some of the 15 hours required in 2007 or hours that can be carried over to 2008. Ms. Cynthia Dunn will be speaking again at these sessions as she did on September 6th. I found her presentation to be very helpful to me personally in the office and look forward to hearing her at the next two seminars.



Speaking of anyone needing more Professional Development Hours (PDH), the Executive Committee feels that the on hands seminar that Tom Snezek will be hosting on Saturday, November 3rd, for Robotics Operation, would probably qualify for CPD credit. Although the intent was to provide some training for technicians that work for our members, a licensed P.S. that has yet to be exposed to Robotics would certainly learn a great deal by actually operating this equipment and would therefore be able to claim the PDH credit for time spent. Tom will NOT be handing out certificates but he will be recording attendance and the attendees should retain their application paperwork. The deadline for registering to attend is October 19th, and the class is filling up fast so do not delay.

The State Executive Committee has informed us that Mark Jones will no longer be serving as Executive Director for PLSO. We wish Mark well in his future endeavors.

As we near the end of my term as President of the Cleveland Chapter, the time for elections of replacement board members is right around the corner. This is your chance to get involved in your

....Continued on Next Page

Jake's Stakes

Amish
Custom Made
Surveying and Construction Stakes

Produced by Jake Shetler
7370 Camp Road
Homerville, Ohio 44235

(Our stakes are high quality hardwood smooth for excellent writing surface)

HARDWOOD STAKE PRICING (Soft wood available upon request)

Marker Stakes

1-1/2" x 3/8" x 48"	\$0.36 ea.
1" x 1/2" x 48"	\$0.22 ea.
1-1/2" x 3/8" x 36"	\$0.28 ea.
1-5/8" x 1/2" x 30"	\$0.25 ea.
1-5/8" x 1/2" x 24"	\$0.20 ea.
1-5/8" x 1/2" x 18"	\$0.17 ea.

Hub Stakes

22" Hub Marker	\$0.13 ea.
18" Hub Wedge	\$0.19 ea.
12" Mine Wedge	\$0.30 ea.
12" Hubs	\$0.15 ea.
9" Hubs	\$0.13 ea.

1-1/2" x 1/2" x 15" Form -A- Drain Stake with nail hole	\$0.17 ea.
1-1/2" x 1/2" x 12" Form -A- Drain Stake with nail hole	\$0.14 ea.
5/8" x 30" Reinforcing Rods - Bundle of 20 = \$27.00	

Large Stake Inventory - Orders Filled Rapidly
Delivery Service Available - Pricing Subject to Order Size
FREE DELIVERY ON LARGE ORDERS

Order Placement: Call Dwight Powers at 330-421-2596 or 330-648-2111

Fax Orders: Attention Dwight at 330-648-2552

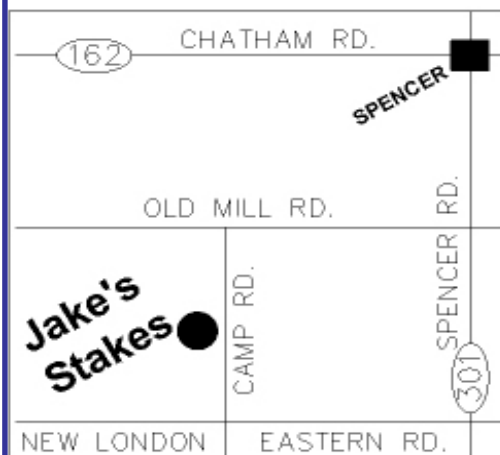

organization combined with the extra perk of earning two PDH's for service. Pete Zwick is the chair for the nominating committee and would be interested in hearing from you if you would like to run for office.

At our last Executive Committee meeting, the board had discussion as to the CPD seminars that we are hosting. As a result of that discussion Louise Veverka, our Program Trustee, will generate a questionnaire which will be included in the ballots that will be mailed out in November. Please look for it and return with your ballot.

To wind this letter up, I want to remind you of the Conference that we are hosting next year and request that you contact Mark Yeager or me to volunteer your time to assist us in the setup and operation of this event. I have to admit that I will never regret getting involved in the Cleveland Chapter several years ago. The Surveyors I have interacted with have shown me the professionalism that is within the PLSO organization from the state to the local level. I urge you to step up to do your part to shape our Chapter.

I look forward to seeing you at our next meeting.

Respectfully,
John J. Bischof, PS

SEMINAR MEETING REVIEW

Today most of us use electronic files daily and so does the rest of the world. Exchanging electronic files can be a hassle if it is not done properly. Cindy Dunn from CCAD Inc. had a very informative presentation on this subject. Cindy went through the pros and cons of the different file types and how to create them. She demonstrated how to include all the linked files that are necessary to maintain the proper appetite of the AutoCad drawing and she also demonstrated different ways to exchange files. I know that many of us are concerned about giving out our AutoCad drawings to others without some kind of security installed. Cindy went over the DWF (Design Web Format) file type that lets other people view and red mark our drawings without the ability to change or edit them. I like this format.



Joseph F. O'Donnell, Jr.

However, if you do need to provide an AutoCad DWG file to your client, you need to include all the linked files that are associated with the DWG file, such as Fonts, Plot Styles Tables, Xrefs and Images. I know from first hand experience how frustrating it is to open someone else's AutoCad DWG file and see a big hole in the center where a Xref is suppose to be. Cindy went over the eTransmit command, which gathers up all the associated files and places them into a ZIP file or an EXE file.

AutoCad is a very complex program with many hidden commands. I have been using AutoCad since 1987 and I'm still learning new things. Also, every year with new upgrades, the AutoCad program is constantly changing. Cindy Dunn will be speaking at the next two seminar meetings and this is a great opportunity to get all your questions answered from an expert with many years experience in the use of AutoCad. Don't forget you can pickup 1 CPD hour as well. Check this issue of Cleveland Surveying News for the registration form.

If you're interested in learning more about Cindy Dunn's presentation, you can download an outline from her web site at:

www.ccadinc.com/download/xchange.pdf.

This year, the Cleveland Metroparks is celebrating its 90th birthday. Maybe this does not mean too much to you, but think about it a little. I have had the opportunity to travel to a lot of places and our park system, our "Emerald Necklace" is the envy of the world.

In 1917, a bill that was passed by the Ohio State Legislature authorizing metropolitan park district boards to levy a .1 mill tax for operating purpose and a couple of years later, another .1 mill tax for capital acquisition. With these measures in place, the "Metroparks" were off and running.

But first, a little history. The Metroparks were the vision of several clear thinking greater Clevelanders, but primarily one man, William Stinchcomb. In 1905, as an engineer for the City of Cleveland, Stinchcomb suggested a series of parks encircling Cuyahoga County and parts of Medina County.

William Stinchcomb was a native Clevelander, born in a *farm house* on Denison Avenue in 1878. He went to work for the City of Cleveland in 1895 as a surveyor. He followed his dream and was a self educated engineer. In 1902, Mayor Tom Johnson named Stinchcomb as chief engineer of parks, directing him to popularize and expand them. In 1905, he wrote a report suggesting the creation of a metropolitan park system. In 1912, he was elected as County Engineer. While supervising the construction on many important road and bridge projects, he never forgot his dream of a major park system.

Around 1913, a park board was appointed but with no taxing powers, so Stinchcomb donated his engineering services to the park board. In 1917, with the new taxing authority, the board offered Stinchcomb the job of Director-secretary. The original metro park property, a 3 acre site in the Rocky River valley, is the site of the Stinchcomb memorial today. By 1920, the park board held title to only 109 acres of land, most of it obtained by donation. By 1930, they held title to almost 9000 acres.

The board asked Stinchcomb to hire the Olmsted Brothers, (possibly Frederick Law Olmsted, the father of modern landscape design?) a landscape architecture firm, to provide technical

assistance. The Olmsted plan formed the basis of what later became called "The Emerald Necklace." The plan included glens of rivers and creeks (lands unsuitable for normal development) and encouraged landowners to donate these areas for park purposes.

The "Great Depression" may have created very serious hardships for most people, but it was a boon for the Metroparks. The federal work-relief projects probably moved the park's development forward by a generation. The Civilian Conservation Corps (CCC), Federal Employment Relief Agency (FERA), Public Works Administration (PWA), and other relief programs had put more than 5,000 men to work

Continued on Page 11....





Cynthia L. Dunn of CCAD inc.

Cindy Dunn has been teaching AutoCAD to engineering and technical professionals since 1986 when she started CCAD inc. By 1993 the face of AutoCAD training changing as more and more students were being integrated into established CAD departments, so CCAD acquired space to conduct AutoCAD training. Although classes held at CCAD frequently include students from different companies, the emphasis on personalized, practical training hasn't changed. Classes typically consist of 2-6 students and materials designed by Cindy address a variety of engineering disciplines. Along with her training responsibilities, Cindy maintains the CCAD Web Site and publishes a monthly AutoCAD Tip Sheet to any interested AutoCAD user.

Cindy has a BS in Industrial Design from Kent State University, has Level 1 & 2 AutoCAD Certification and completed AutoCAD Designer Training in 1994 and Autodesk Visual Basics Training in 1998. She founded the Northeastern Ohio AutoCAD (NORCAD) Users Group in 1988 and served as its Chairperson from 1988 through 1991 and its Newsletter Editor from 1988 through 1994.

Cindy is the presenter for each of the Seminars in the Fall Seminar Subscription:

October 4, 2007

The 1, 2, 3's of Creating Effective Libraries

A little time spent on upfront planning, reaps big time-savings in the long haul.

- Sizing and Scaling Issues
- Insertion Points
- Layer, Color, Linetype, Lineweight Settings
- Blocks vs. Drawings
- Creating Libraries with Tool Palettes

November 1, 2007

Every Good Design Begins with a Solid Foundation

Templates save time and promote a professional image.

- Establishing Styles
- Defining Layers
- Adding Sheet Formats
- Saving and Locating Template Files

Continued from Page 3....

from Michael J. Baker & Associates spoke about the Cuyahoga County GIS at our dinner meeting. The aerial photography had already been flown and is now over a year and a half old! This GIS could be obsolete before it is available to the taxpayers.

There's the snag. Maybe it isn't the taxpayers that concern the county; it's the payers. Cuyahoga County enjoys making money charging the public for public information. Our taxes have already paid for the documents, the copiers, the computers, websites, rent on their buildings and salaries for all the employees. The information doesn't belong to the County agencies. Elected County officials, agencies and employees are stewards of the public trust. That means we are entrusting them with our public property. We shouldn't have to pay for it twice. And, according to OHIO, we should be able to get the information in the same format in which it is stored.

I heard recently, that since the GIS is taking so long, the county is considering making some of it available for sale. Why make it available free to the public when you can sell it on DVD now? *Ka-Ching!* County agencies should be ashamed that they are lining their budgets this way. Cuyahoga County is a sad example of serving the public trust. They have no excuse.

ODOT will email you plans. Lake County has recorded plats on the web. Medina County offers

Continued on Page 12....

September 17, 2007 at the office of John R. Hoy and Associates, Inc.

In attendance: John Bischof, John Hoy, Pete Zwick, Dave Bruckner, Tom Snezek, Bob Hoy, Louise Veverka, Sean Boland, and Joe O'Donnell.

Also in attendance: Jack Hoy

Absent: Tim Feller.



Robert Hoy

Secretary

Dave Bruckner submitted written reports for July and August.

Sean Boland reported on the August Special and September State PLSO Executive Committee meetings.

John Hoy reported he finally received our Chapter roster from State PLSO.

Tim Feller was absent and did not submit a report.

We discussed our seminar meeting format and possible ideas for next Spring's meetings.

Pete Zwick will prepare a questionnaire to be included with the officer ballots and his nomination slate is in progress.



**Your software has changed.
Your clients have new demands.**

Have you kept up?

Your CAD software should support your business goals and meet your design needs. We can help you fit your Autodesk Civil 3D, Land Desktop and Map 3D software to your workflow – and free up your time to do more surveying and less drafting.

We've been your source for Autodesk Surveying, Civil Engineering and GIS software for over 20 years – the right tools for every size survey, mapping and land development project.

Turn to us for the training, implementation and technical support services that keep you productive.

Challenge us – tell us one thing you don't like about your software – and see if we can show you a better way.

Offices throughout Ohio

Phone: 216.834.8326

Web: www.rand.com/IMAGINiT

Email/info: LHorowitz@rand.com

Continued from Page 8....

in Cleveland's metropolitan parks. They cleared and graded picnic and parking areas, transplanted thousands of trees and shrubs, laid water mains, and built roads, foot and bridle trails, culverts, retaining walls, shelters, water fountains, and toilets. By the end of the 1930's, the Cleveland Metropolitan Park District had nine reservations, connecting parkways and just over 11,000 acres of land.

The post-war period brought more growth so that by 1950, the park district held title to over 13,000 acres. By this time, suburban development had pushed to the very edge of the metropolitan parks and beyond, proving the wisdom of Stinchcomb's vision almost a half century earlier.

Ohio's compulsory retirement law would have forced Stinchcomb out of his job as director in 1949, but the law was specially amended and Stinchcomb was asked to stay on. "I don't want to step aside and just rust away," he said. In February 1957, Stinchcomb suffered a stroke as he left his office in Cleveland's Standard building. On June 1st, four days shy of his 79th birthday; he ended an unparalleled public-service career of 58 years, 36 years as director of the park district, -- "a long time," he observed "of sucking at the trough."

In November 1958, a monument designed by sculptor William McVey, the same sculptor who created the statue of George Washington as a young man that stands behind the Celebreze Federal Office Building, was unveiled on a hilltop in Rocky River Reservation, overlooking the horseshoe-shaped valley where Stinchcomb had purchased the first parcel of land for the "Emerald Necklace" in 1919. Stinchcomb was too ill to attend the ceremony and died in January, 1959.

The park system continued to grow and now includes over 20,000 acres of land in 16 reservations. In 1970, the Metroparks assumed ownership and management of the world famous Cleveland Zoo, which this year is celebrating its 100th birthday, but that is another story for another time.

"Bill Stinchcomb and the park system are one institution," a Cleveland newspaper pronounced in 1939. Stinchcomb, a self-taught surveyor and engineer was the only director of the Cleveland Metropolitan Park District until his retirement in 1957. For five decades, he guided its development, watching it mature, fighting for it, giving it intelligent direction.

Though most of his life was spent as either an engineer or an administrator, he did get his start as a surveyor and his impact on the Cleveland area has never been rivaled. He brought parks to an urban area and made them an important part of our daily life. The survey records of the Cleveland Metropolitan Park System can trace their history directly back to William Stinchcomb. I believe that the Cleveland Chapter should nominate William A. Stinchcomb as a PLSO Surveyor of the Past.



[John E. Dailey, Past](#)

Continued from Page 9....

surveys from their GIS organized by Township and Lot.

I wrote once before about a shining example of how to properly serve the public trust. The Summit County Engineer decided to scan all the documents in their files. Now, if you take them a 60 GB external hard drive they will copy it for you for \$10.00. What do you get? Over 9,000 files of images - data & topography from their GIS, over 2,000 pages of old taxmaps, over 5,000 lot split surveys, over 500 vacation/dedication plats, over 1,000 subdivision plats (more than 3,000 sheets), over 300 subdivision improvement plans (more than 4,500 sheets), over 3,800 surveyor records (surveys of government/county properties and buildings), over 1,500 field books (every page), over 3,000 pages of non-recorded surveys, over 800 pages of plans for ODOT projects and I-77 freeway plans, hundreds of pages of turnpike plans, almost 9,000 pages of road records, over 16,000 pages of road improvement plans, almost 500 pages of plans for railroads – Ohio canal & Ohio Edison, over 4,000 pages of ditch records and plans, annexation plans, cemetery plans, township maps from 1870 & 1937 and much more. For the cost of making a copy and in the format they use in their files.

The Cuyahoga County Engineer has also scanned much of their files and many more of their files originated in digital format. If you want a copy of the taxmaps, pony up \$75.00 for a CD. Who is serving whom? The County Recorder is as bad. All recorded documents are scanned. They keep no paper originals anymore. On their website you can get copies of the deeds (if you can crawl through their database). However, plats are not available online. \$17.28 per page in person only and you get a reduced print on paper.

Continued on Page 20....

HIGH GRADE HARDWOOD SURVEY STAKES

DELIVERY AVAILABLE

- TOPCON DEALER
- SOKKIA DEALER
- FIELD SUPPLIES
- INSTRUMENT SALES, SERVICE & RENTAL
- GPS TECHNOLOGIES
- FIELD EQUIPMENT



ROBERTS

Surveying Supplies

WWW.ROBERTSSURVEYING.COM

5758 Ridge Road Parma, Ohio 44129

Phone (440) 842-2218

Fax (440) 842-0802

Although this educational opportunity is designed for technicians/field personnel it is open for anyone to attend. A professional can use this as CPD time provided they comply with documentation requirements of the State Board of Registration:

- (1) A log specifying the type of coursework or activity, its location and duration along with the instructor's name, and the number of continuing professional development hours earned;
- (2) Certificates of completion or other evidence verifying attendance.



Tom Snezek
Education Trustee

FALL 2007 TECHNICAL SEMINAR

Saturday, November 3rd, 2007
9:00 a.m. to 12:00 noon

FIELD OPERATIONS - TECHNICAL SEMINAR
FOR PARTY CHIEFS, INSTRUMENTMEN AND FIELD TECHNICIANS
(This is not intended as a CPD credit seminar)

The Cleveland Chapter is offering a one-day class at the Cuyahoga County Engineers Test-Lab training facilities located at 2429 Superior Viaduct, Cleveland, Ohio 44113.

FIELD OPERATIONS WITH ROBOTIC INSTRUMENTS

Presented by Dale Glancy and Dennis Fay from City Blueprint of Toledo

Instructional seminar followed by a field demonstration outdoors at the Test-Lab. A question and answer session will be included along with pizza and beverages immediately following the demonstration, so bring all your issues and notes.

The cost of the seminar is \$50.00 per attendee and the checks should be made out to the "Cleveland Chapter, P.L.S.O." The deadline for registration is October 19th, 2007.

Please mail your check and application form to: Thomas M. Snezek, P.S. Education Committee Chairman.
3496 Colletta Lane, Cleveland, Ohio 44111.

If you have any questions call or email me. My contact information is: (216) 348-3846 or dadsurv@hotmail.com.

DIRECTIONS:

From Downtown Cleveland go west on Superior Ave. Cross the Veterans Memorial Bridge, (Detroit-Superior to some). Turn right onto West 25th. Then right again onto the Viaduct, (right in front of St. Malachi Church). The Test Lab will be on your right.

NAME: _____ PHONE: _____

NAME: _____ PHONE: _____

NAME: _____ PHONE: _____

COMPANY: _____

REGISTRATION

FALL 2007

TECHNICAL SEMINAR



2010 Madison Avenue
Toledo, OH 43604

Sales • Service • Rental
Leasing • Training • Support

Trimble TSC2 Controller

Key Features

- Highest flexibility for optical and GPS surveying
- Wireless operations in both the field and office
- Exceptional versatility, efficiency, and freedom
- Choice of powerful TDS or Trimble software.
- Flexible Communication Options
- Increase your productivity
- Built for field conditions



For Northwest Ohio Call Dennis Fay at 419-206-0308
for onsite demonstration.

Trimble S6 Robotic Total Station



Key Features

- 100% cable free
- Reflectorless EDM
- SurePoint accuracy
- Internal smart battery
- MultiTrack technology
- Increase your productivity
- MagDrive servo technology
- Coaxial Optics, EDM, Laser Pointer, Tracker



For Northeast Ohio Call Dale Glancy at 216-513-3083
for onsite demonstration.

Tel: (419) 243-7271 Fax: (419) 243-6418 Toll Free: 800-548-1503
E-Mail: cbt@cityblueprintoftoledo.com

Due to some email headaches, the report for the July meeting was not in the last newsletter. This newsletter contains three reports. The July meeting, a special meeting in August and the September meeting.



Sean Boland

Chapter Delegate

State Executive Meeting – July 20, 2007

- 1.6 PLSO Administrative Office – Mark Jones was in the hospital.
- 4.1 24 Quarter Hour Requirement for 13SE – Dean Ringle reported that a formal report will be submitted to the Executive Committee in September.
- 4.2 Donations to State Line Committee – No donations needed at this time. Will ask again when money is needed. Chapters can donate money without going to the Executive Committee, make checks payable to "PLSO State Line Fund".
- 5.1 New Members – Eight new professional, one associate, one student and four reinstatement members. Motions were made and passed accepting all members. One of the professional members is from the Cleveland Chapter.
- 5.2 Status of the University of Akron Survey Program – The programs is ten years old; over one hundred graduates; 80% passing rate on the fundamentals exam. Mike Besch is looking for input from PLSO to see if their program is what PLSO thinks it should be; would like opinions from Chapters by October.
- 7.413 Summer Seminar – Registration for the summer seminar at the Kalahari hit the break even point. Golf outing and PAC dinner cancelled.
- 7.414 Business Seminar – Flyer for seminar in the mail. Always check PLSO website for seminar and conference updates.
- 7.45 Legislation – SB 189 - Lake Erie Shore Definition. This bill is being monitored closely by PLSO legislation committee - language in the bill that defines the boundary line as the "normal waterline" is not as clear as the current ODNR Rule which uses an existing elevation of 573.4, which is measurable and identifiable by land surveyors. The Committee will testify when the bill comes up for hearings. The septic HB was rescinded.
- 7.48 Scholarships – Two scholarships for 4 year students were approved – Josh Zimmerman and Scot Lowery - \$1200 each. Two scholarships for 2 year students were approved – Nate Meyer and Mindy Hejduk (Cleveland Chapter) - \$800 each.
- 7.49 Scholarship Fund Board – Looking to raising money for the scholarship fund (fund raisers, etc.)
- 7.50 Management Review – Reviewing PLSO management staff this fall.
- President-Elect – Paul Dinan looking for nominees for State Executive Committee by September 14 meeting. Positions are president-elect, secretary and treasurer.

Special Executive Meeting on August 22, 2007

On August 22, State President Bradley J. Kramer called for a special meeting of the Executive Committee to address concerns with our Executive Director. On August 11, the Past Presidents Advisory Committee held a meeting and recommended the dismissal of the PLSO Executive Director Mark Jones. The Committee based the decision partly on the non-professional manner in which the Executive Director performed his duties, some of which were his very poor relationships with other professional societies, boards and agencies, his inability to meet the deadlines of PLSO business, and his strained working relationships with the PLSO administrative staff as well as the PLSO Executive Committee.

At the August 22nd meeting, President Kramer went into Executive session to discuss the matter of the Executive Director. There was a lengthy discussion, in a very professional manner, including advice from legal council. Two motions were made following the recommendations of the Past Presidents Advisory

Continued on Page 16...

Continued from Page 15....

Committee. The first was to dismiss the Executive Director effective immediately. The second, also recommended by the Past Presidents Committee, was to offer a separation package which included 320 hours of pay. To receive the package, Mark Jones would have to sign an agreement for no legal action against PLSO. Both motions carried unanimously.

September 14,2007 Executive Meeting

4.2 Executive Director

President Kramer called for Executive Session at which time the subject of Executive Director was discussed. President Kramer said that he, President Elect Dinan and Past President Akins met with Mark Jones on August 23, 2007. At that meeting, they told Mark the decision of the Executive Committee was to terminate him as Executive Director of PLSO and he was offered the severance package which included 320 hours of pay. By signing the offer, Mark would agree to no legal recourse against PLSO or its Officers. Jones refused to sign the offer. He came back at a later date to President Kramer with a severance package of his own. The major difference was the monetary value. He asked for \$43,680 - an equivalent to nine months of salary. This offer was not considered since the original offer was non-negotiable. The time period for the original offer had expired at 12:00 noon the date of the Executive meeting. The Executive Committee decided to extend the original offer to 12:00 noon Tuesday September 18, 2007. If Mark Jones did not sign by that time, then the offer would be off the table permanently.

5.0 New Business

5.2 Machine control position statement. ACEC/COPS is asking the PLSO membership to review proposed language to be recommended on plans where three dimensional data is being created for use in the operation of GPS guided construction. **Please review the enclosure on page 18 and send me any comments. I have to return comments to the October meeting.**

7.411 Annual Conference Updates

I asked for and was granted seed money for the Annual Conference in Cleveland, February 2008. With the recent development with the Executive Directors' position, the Conference Committee felt that they should take on more of the responsibility from the State.

7.48 Scholarship

Revisions to the rules and qualifications for the annual memorial scholarship awards were approved. **(see the approved document which starts on page 19).**

9.0 President-Elect's Report

The list of Nominees for the 2008 Executive Committee were announced:

President-Elect	Dean Fredrick
Secretary	Jim Keyon Tom Silva
Treasurer	Rion Meyers
NSPS Governor	Mike Besch

Please contact me with your comments on the machine control position statement as soon as possible. Thank you.

Sean Boland 216-701-5027
saboland@gmail.com

2008 Annual Conference Report

Conference Dates: Feb. 7-8, 2008

Location: Renaissance Cleveland Hotel

I met with Past President Bob Atkins on September 6th to discuss the conference. In light of the changes happening at the State office, Bob is the PLSO State level contact for the 2008 Conference. Bob provided us with copies of the information from the State files. We received seed monies from PLSO and Pete Zwick volunteered to be our Finance Chairperson.



Mark Yeager
2008 Conference
Chairman

The Conference Committee will continue working with the State office along currently established guidelines for most all aspects of the conference. Initial objectives include having the registration form available on the web by November and a cut off date for pre-registration of January 15, 2008. Walk in registrants will be taking their chances that space is still available.

The schedule of the next few meetings : Oct. 1 - 5:30pm, Oct. 15 - 5:30pm,
Oct. 29 - 5:30pm, Nov. 19 - 5:30pm
At the office of John R. Hoy and Associates, Inc.

Mark your calendars and stay tuned for more information on the event in the coming months.

Calendar

October 1	2008 Conference Committee Meeting
October 4	Seminar Meeting
October 12	State Executive Committee Meeting
October 15	2008 Conference Committee Meeting
October 15	Executive Committee Meeting
October 19	Cleveland Surveying News Deadline
October 19	Registration Deadline for Field Technician Seminar
October 25-26	PLSO Fall Seminar, Cherry Valley Lodge, Granville
October 29	2008 Conference Committee Meeting
November 1	Seminar Meeting
November 3	Field Technician Seminar - Cuyahoga County Test Lab
November 9	State Executive Committee Meeting
November 19	Executive Committee Meeting 2008 Conference Committee Meeting
December 10	Executive Committee Meeting (if needed)
December 14	State Executive Committee Meeting (if needed)
January 11, 2008	State Executive Committee Meeting
January 14, 2008	Executive Committee Meeting
January 18, 2008	Cleveland Surveying News Deadline
January 24, 2008	Annual Meeting
February 7-9, 2008	PLSO Annual Conference, Cleveland

Executive Committee Meetings and 2008

Conference Committee Meetings

are held at the office of :

John R. Hoy and Associates
4562 W. 130 St., Cleveland

and are open to all members of the
Chapter who want to attend.

Machine Control Position Statement

***COPS (Council of Professional Surveyors) is a professional community within
ACEC (American Council of Engineering Companies)***

WHEREAS: Professional Engineers produce plans showing the position of proposed improvements and specifications detailing the procedures/processes to be utilized in the construction of the project.

WHEREAS: These plans;

1. Are used to create three-dimensional data used in the operation of GPS guided construction equipment, and
2. Specific events during the construction process.

WHEREAS: The success of a machine control project is dependant on the quality of the DTM produced to represent the plan and the quality of the project GPS calibration used to control the Machine Guidance system.

THEREFORE: COPS herein recommends that Professional Engineers state in construction plans and specifications they prepare that Professional Land Surveyors or Engineers must be in responsible charge of the DTM creation and site calibration.

In addition, having appropriate contract language can help avoid costly defense fees when engineering firms are named in a lawsuit involving the use of their plans, yet the firm had nothing to do with the creation of the DTM used by the contractor. Moreover, having appropriate contract language can establish the activities engineering firms will conduct during construction and how firms are to be compensated. During the ACEC Annual Convention in Washington, D.C. earlier this year, ACEC/COPS made a thought provoking presentation aimed at developing language suitable for including in contracts and specifications and on plans to address this growing issue. A draft of what was developed can be found on the following page. ACEC/COPS encourages the membership to review this language, offer comments to improve it, and consider implementation.

Suggested Language for Use in Construction Plans Where Machine Guidance May be Used:

1. These plans are not suitable for machine guidance use or purposes.
2. Should these plans be used to prepare files for machine guidance a Professional Land Surveyor and/or Engineer shall be in responsible charge of Digital Terrain Model (DTM) creation and site calibration.
3. All DTM files used for machine guidance shall be reviewed by the Engineer of Record prior to use.

Suggested Language for Use in Contracts Where Machine Guidance May be Used:

1. Unless specifically stated herein, plans prepared under this agreement are not suitable for machine guidance use or purposes. No guarantee is made that the electronic data systems or file structure used by the firm will be compatible with the electronic systems used by the contractor.
2. Information shown on the permitted plans shall take precedence over the electronic files data.
3. Should plans prepared per the Scope of Services of this agreement be used to prepare files for machine guidance, a Professional Land Surveyor and/or Professional Engineer must be in responsible charge of Digital Terrain Model (DTM) creation and site calibration.
4. All Digital Terrain Model (DTM) files created by someone other than the Engineer of Record and to be used for machine guidance shall be reviewed by the Engineer of Record prior to use.

**PROFESSIONAL LAND SURVEYORS OF OHIO, INC.
ANNUAL MEMORIAL SCHOLARSHIP AWARDS
RULES AND QUALIFICATIONS**

- PURPOSE:** The purpose of the PLSO Scholarship is to honor and promote those students seeking a career in surveying who will support and represent Ohio and the PLSO surveying standards of the future.
- GENERAL:** The Professional Land Surveyors of Ohio (PLSO) shall present, annually, scholarship awards to pay towards tuition expenses of students qualified as described below. These scholarships will be available to students preparing for their final year of an **Associate of Applied Science** Program or their Junior or Senior years **of** a four year Bachelor of Science **Program in Surveying or Geomatics**.
- ELIGIBILITY:**
1. The student must be enrolled in a Surveying Degree Program at a state accredited college or university located in Ohio.
 2. The student must be **planning to enroll and use these monies for** their final year of a two year **Associate of Applied Science Surveying** Program, or **their** Junior or Senior year of a four year Bachelor of Science Surveying Program.
 3. The student must have an accumulated grade point average of 2.50 or above (based on a 4.0 point system).
 4. The student must be recommended for this award by a faculty member within the surveying department of the student's school.
 5. The student should show a continued drive to become a practicing surveyor and exhibit those qualities which are essential in becoming a professional person.
 6. The student must be a participative Student Member of PLSO.
 7. **The total amount of awards for any given year shall be established by the Scholarship Fund Board Committee after consulting with, and gaining the approval of the Scholarship Fund Board. The Scholarship Fund Board shall make the amounts of available funds known to the Scholarship Committee by June 1.**
 8. **Full-Time Students:** A goal of at least three (3) scholarships in the amount of **\$2,000.00** each **may** be awarded annually to those students who are enrolled **full-time** in a Bachelor of Science Surveying Program. A goal of at least three (3) scholarships in the amount of **\$1,000.00** each **may** be awarded annually to those students who are enrolled **full-time** in an **Associate of Applied Science Surveying** Program.
 9. **Part-Time Students:** **Scholarship awards to part-time students shall be determined in proportion to the ratio of the number of hours enrolled to the minimum number of hours required for full-time status, as defined by the particular college or university. (For example: 8 hours enrolled while the university requires 12 hours for full-time status = 2/3 or \$1,330.00 for B.S. Program or \$660.00 for A.A.S. Program.)**
 10. No student may receive more than two (2) **PLSO** scholarships.

STUDENT APPLICATION:

A student may inquire as to the procedure involved in applying for a PLSO Scholarship through the offices of his/her school faculty or advisor, through his/her local student chapter of PLSO, or through the PLSO State Office. Completed application forms and other requested materials shall be submitted to the Surveying Faculty Advisor or Surveying Department by May 1 of each year. A faculty screening committee shall evaluate the applications, determine eligibility, and make up to four (4) recommendations to the PLSO State **Office** no later than June 1. Application forms will be available from the PLSO State Office or through the Surveying Department of their school.

SCHOLARSHIP COMMITTEE:

The Scholarship Committee shall annually review applications for PLSO scholarships and make recommendations to the Executive Committee at the July meeting. The Committee shall periodically review the eligibility qualifications and award amounts and make recommendations to the Executive Committee. Voting members shall include the Scholarship Committee Chair, PLSO's President, President-Elect,

Continued from Page 19....

Immediate Past President and Education Committee Chair. Any chapter who offers scholarships should provide a non-voting member to the Scholarship Committee.

SCHOLARSHIP AWARDS:

At the Executive Committee's regular July meeting, the **Scholarship** Committee shall present to the Executive Committee of PLSO, the names of students recommended for the awards. The **Executive** Committee shall either approve or reject the recommendations of the **Scholarship** Committee at the same July meeting. The announcement of the awards to the recipients of the scholarships shall then be made by the PLSO **staff** as soon as possible thereafter. The recognition of the awards to the recipients shall be made by the President of PLSO at the annual meeting. These scholarships shall be paid directly to the school in the name of the student by August 1.

SCHOLARSHIP FUND BOARD:

The Scholarship Fund Board shall accept, invest, monitor, review, re-invest, and distribute funds exclusively set aside for scholarships. The recipients of scholarships and the amount thereof shall be determined by the Executive Committee with the assistance of the Scholarship Committee. The Scholarship Fund Board shall consist of five (5) members, each of whom shall serve for five (5) years. One new member shall be appointed annually by the President at the March Executive Committee meeting. There shall be no more than one member from any one chapter. They shall be members in good standing of PLSO and reside in the State of Ohio. They may succeed themselves in office.

AS ADOPTED BY THE PLSO EXECUTIVE COMMITTEE SEPTEMBER 14, 2007

Changes are shown in red.

Continued from Page 12....

What will be available online through the mythical GIS? Only the internet gremlins know for sure. I think that as long as there is a chance for the county to make some money, I'll be dead and buried long before the GIS magically appears. As a taxpayer in Cuyahoga County I'm entitled to my opinion. Right now, I'm disgusted with this situation.



Derek Barker and Joe Seppi of Michael J. Baker & Associates

Circa 5/4/2006 (shown for historical reference only)