

A photograph of a forest with large trees and a green undergrowth. The trees have thick, dark trunks and are surrounded by a dense carpet of green plants. The sky is visible through the branches.

Cleveland Surveying News

April 2009

- Lake GIS Review
- ODOT VRS Update



Cleveland Chapter of PLSO

**P. O. Box 81713
Cleveland, OH 44181-0713**

Volume 8, Issue 2
Circulation: 214 issues

Editor & Photographer: Robert Hoy, P.S.
Proof: John G. Hoy, P.S.
Website: Rob Krause, P.S.

2009 Advertising Rates:

Full page: 9.8"h x 7.3"w \$400 yr.
One-half page: 4.8"h x 7.3"w \$200 yr.
One-sixth page: 3"h x 3.6"w \$80 yr.
Single Issue Full Page: \$100

Help Wanted or Position Wanted up to
one-half page is \$30.00 per issue.

Contact: Robert Hoy, k666@cox.net

Contents

Features

ODOT VRS Update	6
N.E. Ohio GIS Review Part 4 of 4	19

Meetings

April 2nd CPD Seminar Announcement	4
March CPD Seminar Review	11

Articles

Random Lines by John Dailey	7
Things I Wonder About... by Michael Straub	12

Reports

Editor	3
President's Message	6
2011 Conference	14
Secretary - Jan. Excom. Meeting Minutes	15
Communication	16

Miscellaneous

PLSO Contact Information	4
Data Bank Survey Discs	15
NGS CORS Map	17
Chapter Calendar	21

ADVERTISER INDEX

3	Imaginit Technologies	5	Leica Geosystems
7	Aerocon Photogrammetry	9	City Blueprint of Toledo
10	Roberts Surveying Supplies	13	Precision Laser & Inst.
20	Jake's Stakes	21	Avatech Solutions

2009 Executive Committee

President	Timothy J. Feller	440-585-9800	timf@mcsteen.com
President-Elect	Michael A. Straub	440-333-1700	mikes@straubsurveying.com
Past President	Peter D. Zwick	440-235-2729	zwick@eng.ohiocoxmail.com
Treasurer	John J. Bischof	440-439-1999	bischof@cvelimited.com
Secretary	Michael A. Ackerman	216-642-1130 x115	mackerman@dgbassoc.com
Delegate	George A. Hofmann	440-234-5544	george_hm@ameritech.net
Trustees			
Communication	Robert G. Hoy	216-389-7677	k666@cox.net
Education	Robert A. Papotto	440-934-7878	bobpapotto@wideopenwest.com
Program	Eric W. Short	440-366-9618	shorte@windstream.net
Membership	Charles W. Flanigan	330-769-4812	cfpeps@neo.rr.com

Last month I included an email from PLSO member Steve Hyde regarding the Communication Report in the [January 2009 CSN](#). Steve was in support of what the report had to say. This was the first email or letter in response to a previous article that was published in this newsletter. You might think we're publishing the good feedback and ignoring the bad, right?

We have heard many good comments about our newsletter from members and non-members in the surveying profession from around the state; however, Mr. Hyde's email was the only email or letter I have received about content published in our newsletter.

Do you have a comment about an article, report, or news item appearing in this newsletter? Send me an email and be sure to include your name and location or PLSO chapter. Just click on my name below.

[Robert Hoy](#)
CSN Editor

Web Sites Previously Featured

www.clevelandmemory.org - historical photographs of the Cleveland area.

www.railsandtrails.com - scans of very useful old township, USGS, railroad, etc. maps.

<http://benchmarks.scaredycatfilms.com/OH.html> - NGS monument database with Google Map interface (much easier to use than the NGS Map Viewer)

<http://msc.fema.gov/webapp/wcs/stores/servlet/FemaWelcomeView?storeId=10001&catalogId=10001&langId=-1> - online FEMA FIRMS (Flood Insurance Rate Map)

<http://ohiodnr.com/water/oeplats/tabid/3300/Default.aspx> - scans of canal maps in Ohio

Know of a web site that other surveyors could benefit from visiting? Send the [editor](#) an email to share your resources!

On the Cover:

"It will be Green again"
Rocky River Reservation,
Cleveland Metroparks

© 2008 Robert Hoy

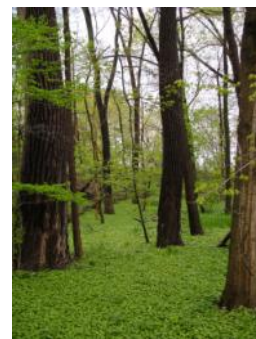



CIVIL 3D FOR SURVEYORS

The training you need from IMAGINiT – The Strength behind the Solution

Finally, the survey software and training you've been waiting for.

Your civil engineering department or the firms you survey for have already switched to Civil 3D. Life would be easier, and your time would be more productive, if you could take advantage of it too. We have the class that will take you through the steps of a typical survey workflow: field to finish – designed by surveyors for surveyors. You will receive a certificate that you may use for Professional Development Hours.

Need AutoCAD Civil 3D or Map 3D software? Need help getting started? We've assisted one-man firms and ENR 100 firms, as well as city and county engineers throughout Ohio. With over 100 engineers, surveyors and Autodesk certified instructors, IMAGINiT delivers valuable training and implementation programs designed to empower your team.

Contact Kristen Hannan or Len Horowitz to get started.



TECHNOLOGIES

A RAND Worldwide Company

The largest ATC provider in North America



Authorized Training Center

www.rand.com/imaginitt • Cleveland office: 216-834-8300

Training . Implementation . Software Development . Consulting . Data & Document Management . Asset Management . Design Visualization . Support

Thursday April 2nd



Schedule

7:00 Registration
7:15 President's Announcements
7:20 Speaker

Reservations

Reservations are not being taken.
If you have an questions, please
contact our Program Trustee:
Eric Short 440-366-9618 at home.
shorte@windstream.net



Eric Short
Program Trustee

Speaker: J. Kevin Kelley - 1.5 Hour Session

Mr. Kelley is the Information Technology Administrator for Cuyahoga County.

Topic: Get a first hand demonstration of the Cuyahoga County GIS by Mr. Kelley on a 64 inch wide screen display.

Location: Cuyahoga County Engineer's office at 2100 Superior Viaduct in Cleveland

- This session has limited seating which members that paid for the **Spring Subscription** will fill.
- This session is closed to new reservations (non-subscribers)
- **No Meal provided**

[Click Here](#) for a full map page to the seminar.

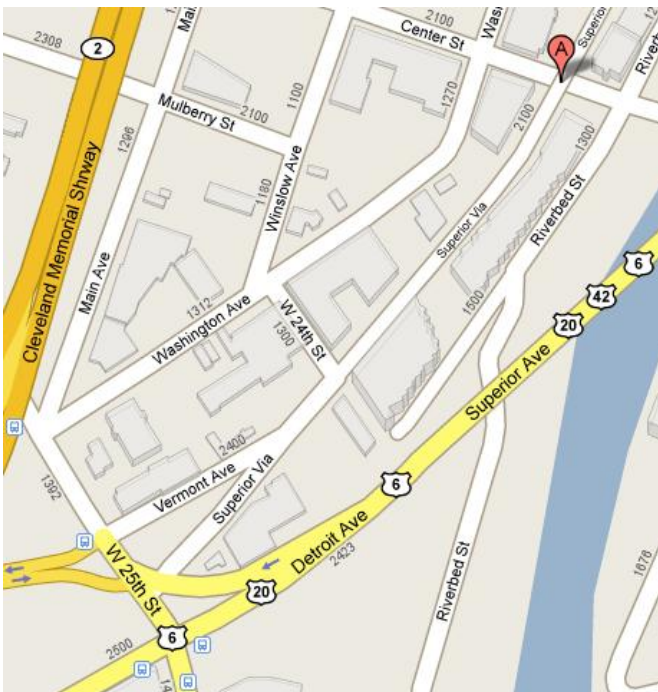

PLSO Contact Info

Please check and update your contact information in the **Members Only** section of the State PLSO website: ohiosurveyor.org

Click on the **Members Only** button on the left side of the home page:

User ID: will be your PLSO Member Number (found on your dues invoice)

Password: will be the last 4 digits of your telephone number on-file with State PLSO.

Also check out the **Downloads** section within the **Members Only** section. As time goes by more and more items will be placed in this section to disseminate information in a more timely and more efficient manner.

Total solutions from the leader in laser scanning



With Leica Geosystems' market-leading 3D laser scanning technology, success and profitability are within your reach. Are you scanning yet?

■ **Industry's most versatile, popular & fast scanners**

ScanStation 2 is the industry's most versatile, popular and fastest scanner for general topographic, as-built and quantity surveys. For close-range as-builts, nothing beats the compact, ultra-fast Leica HDS6000 phase scanner. Cyclone software drives them both.

■ **Comprehensive, efficient software**

Cyclone™ and CAD plug-in CloudWorx™ are industry standards for quickly processing rich laser scan data into any type of deliverable.

■ **Easy-to-learn**

Leica Geosystems newest High-Definition Surveying™ solutions are field-friendly, CAD tech-friendly, and client-friendly ... making it easier for all to profit.

■ **Industry's broadest support resources**

You not only benefit from Leica Geosystems' deeper staff resources, but also from the scanning industry's largest and most active user network.

For more info, visit www.leica-geosystems.us
or call 1-866-920-2300 x 2374

- when it has to be right

Leica
Geosystems

www.PLSO.com

Executive Director, Melinda Gilpin was introduced at the Annual Conference in Columbus on February 13, 2009. I personally am happy to see this position being filled, for as some of you may be unaware our association has been without an Executive Director for approximately a year. Any organization that desires success and longevity needs to have focused, responsible and consistent leadership. With this leadership comes the opportunity to accomplish both short and long term goals. With that being said I welcome Melinda to our organization and look forward to working with her in whatever capacity.



Timothy Feller
President

In the future, I am hopeful that our chapter could establish an editors review panel. The purpose of a review panel would not be to censor one's opinion, but to present a fair and balanced opinion. The Cleveland Chapter's Newsletter is one of the finest, if not the best, newsletters around. Everyone has access to this newsletter and many people take advantage of it because of its quality and content. My feeling is that, if we are going to publish one's opinion, another opposing opinion should also be published in the same edition.

This would accomplish two things. One being that anyone who reads the article would not get the impression that the entire Board or majority of the Executives have the same opinion. The second would be that it could possibly stimulate others to formulate opinions or thoughts on the subject. I would entertain anyone's thoughts or ideas on the subject. I am best reached at timf@mcsteen.com

Timothy Feller

ODOT VRS System Update

Use of the ODOT VRS system can eliminate the need for expensive and security problem base station setups similar to the one shown below.



The ODOT Virtual Reference Station (VRS) system very soon is moving to a yearly fee system.

This VRS system allows users with a single GPS rover unit, data capable mobile phone (including data plan) to perform surveying without a base station equipment setup. The VRS provides the user with GPS data from its nearest CORS (continually operation reference station) as its way to provide position to just a single GPS rover. ODOT has 52 CORS's throughout Ohio.

ODOT has been providing their VRS at no charge to users who request access for the past few years; however, within the next month or two the yearly access fee will be \$500 per license/unit.

At your next local chapter meeting, ask around and you'll probably find colleagues that are using ODOT's VRS system or know of companies that do.

To request information or access to the VRS:
cors@dot.state.oh.us or call 614-275-1359

More Information:

<http://www.dot.state.oh.us/Divisions/ProdMgt/Aerial/Pages/VRSRTK.aspx>
<http://www.dot.state.oh.us/Divisions/ProdMgt/Aerial/Pages/CORS.aspx>



Aerocon Photogrammetric Services Inc
Dedicated to providing quality photogrammetric services since 1967

- **Aerial Photography**
- **Digital Orthophotography**
- **Digital Topographic Mapping**
- **Analytical Triangulation**
- **DTM/DEM Surface Generation**
- **LiDAR**
- **Airborne GPS**
- **GIS Services**
- **Volumetric Inventories**

4515 Glenbrook Road
Willoughby, OH 44094-8215
440.946.6277
440.946.2646 Fax
e-mail: skymap@aerocon.com
www.aerocon.com



Random Lines

Let's continue with the words of Joshua Varney from 1911:

"Plumb-bobs were used on uneven ground, but it was necessary to support the pole in the middle, or the sag would vitiate the measurements. Much may be said in favor of poles for accurate measurements, one strong point in their favor being that the effects of temperature and moisture on their length are negligible quantities. Those subdivisions, which were made with poles, generally show accurate work. If tapes had not been introduced, the changes in transportation would have forced a change. Until later than 1890, we kept horses and vehicles to transport our tools. Trolley cars now reach nearly all parts of the county, but they have no place for 20-foot poles, and there have been threats to exclude our line rods.



The records of the work done by Ahaz Merchant and his son, Aaron, seem to justify especial notice of them among the early surveyors. Neither of them lived to what may be called old age'; Ahaz, '68 years. (1794 to 1862); Aaron, 58 years, (1817 to 1875).

Our Recorder's office shows a very large percentage of the recorded surveys previous to 1875, signed either by Ahaz or Aaron Merchant, and we know that a large part of their work was performed among forest trees on land, now covered with paved streets, and brick, stone and frame buildings. We find their work is of a high order, and the surveyors of today recognize this fact. Evidence that they had the confidence of the people is found in the fact that during the 65 years from the organization of the county in 1810, to 1875, the father and son held the office of County Surveyor 30 years. A list of the incumbents will show this and will be of interest here.

Until 1832, they were appointed by Court and the incumbents were:

[\(Continued on Page 8\)](#)

(Continued from Page 7)

S. S. Baldwin 1811 to 1823, inclusive.	13 years
E. Foote 1824 to 1828, inclusive,	5 years
Ahaz Merchant 1829 to 1833, inclusive,	5 years

After 1833, they held by Election and the incumbents were:

Ahaz Merchant 1834 to 1836, inclusive.	3 years
Y. R. Coon to 1837 to 1839, inclusive,	3 years
W. H. Knapp, two terms 1840 to 1845, inclusive,	6 years
Ahaz Merchant, two terms 1846 to 1851,	6 years
J. C. Saxton 1852 to 1854, inclusive,	3 years
Aaron Merchant, five terms. 1855 to 1869, inclusive,	15 years
John M. Ackley, two terms 1870 to 1875, inclusive,	6 years

TOTAL: 65 years

Between 1860 and 1870, the population of Cleveland increased from 43,000 to 93,000. Real estate values rose correspondingly, and it is no discredit to the Merchants to say that the time had come for a higher grade of work. Mr. Ackley realized this, and with the same tools, he had commenced to do a higher grade of work and was demanding it from those in his employ.

Well do I remember the first description in a deed in which I noticed seconds were used in giving the bearings of lines; it was made by an employee of Mr. Ackley. Since then I have made some effort to keep up with the procession, but at that time I thought it was an assumption of accuracy, which was not attained in fact.

Exactitude is not attainable. An error of 1/100 of a foot may express itself in a value of from less than one cent, to more than \$20.00. Land values are rapidly rising in this City. If a skyscraper is to be built, it is important that all the land shall be utilized; it is more important that it shall not become an encroachment. Habits are so easily formed that it is dangerous to do anything but the best we can, where property rights are affected. Knowing, however, that exactitude is not attainable, we may discuss the question as to how large an error may be ignored. By what rule shall we determine this? When we are making original surveys, that is, surveys by which property is to be conveyed, if we do our duty, we will leave monuments to govern the distances, and law-suits are not likely to grow out of our work. In such surveys we may, with propriety, compare the value of the land affected, with the value of the time required to reduce an error, but when we are locating land previously conveyed, law-suits are liable to result, in which case the value of the land is but a small factor in the problem.

(At this point, Varney compared several measurements made by different surveyors along some of the Cleveland streets. These have not been copied here.)

There is some uncertainty in No. 1, because the stones to which Walter measured were set after the Merchant survey. Merchant used a chain; Walter used a tape. In No. 3, Varney used a stone at the east end, set by Merchant, and a stone, set by Hartnell, at the west end. Merchant used poles. In No. 8, the monuments used by the others were set after the Pease survey. Pease probably used a Gunter's chain. The others used tapes.

Between 1872 and 1880, steel tapes came into use, making better work possible, and their usefulness was greatly increased by Mr. Clarence H. Burgess, who made a careful and thorough study of the effects of strain and temperature, and was the first among us to procure from the United States Coast

(Continued on Page 10)

Your
Complete
Source



Sales • Service • Rental • Leasing • Training • Support

 **Trimble**



SOKKIA



SCHONSTEDT
INSTRUMENT COMPANY

Lufkin

CRAIN



ROLATAPE
CORPORATION

CST

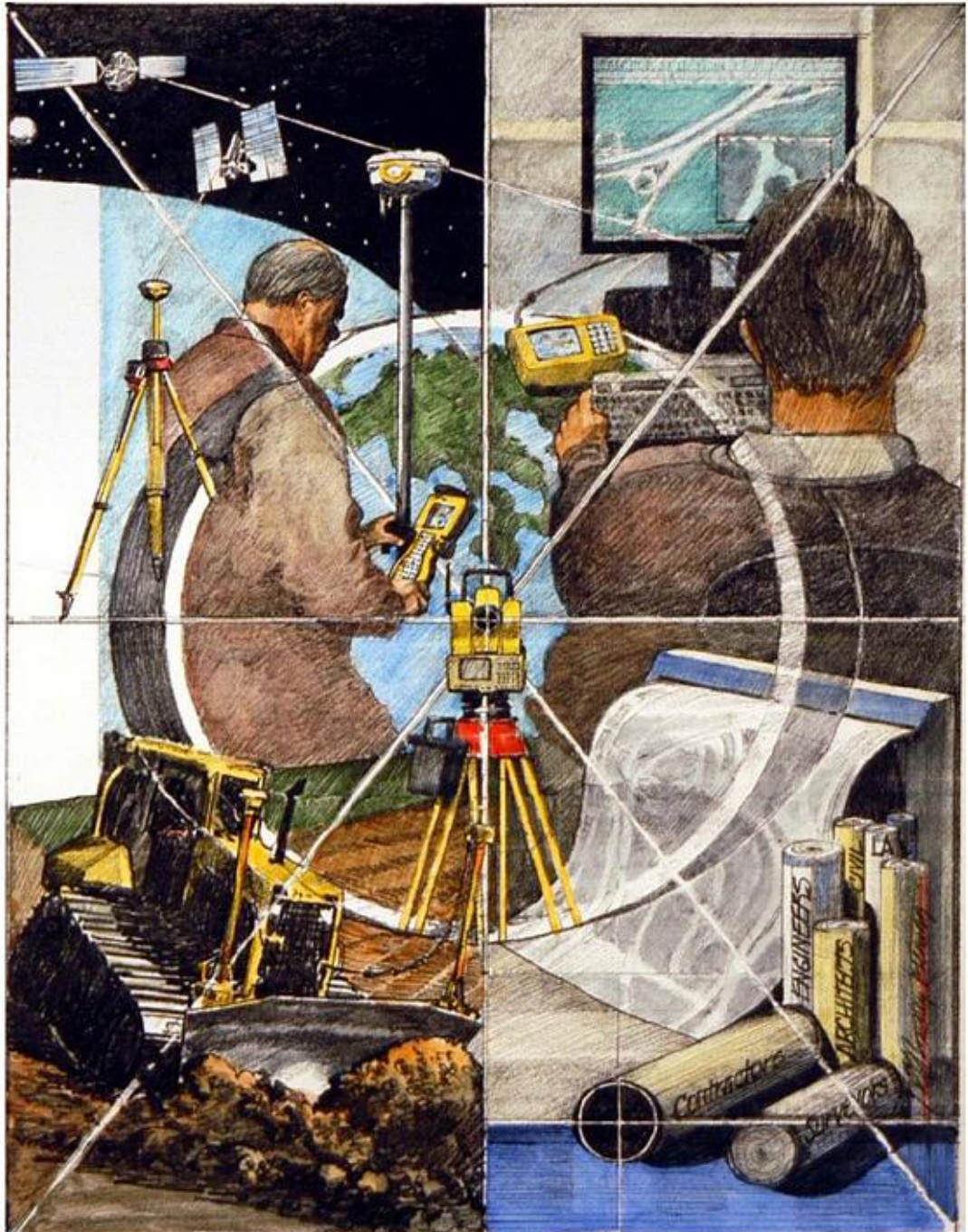

2010 Madison Avenue - Toledo, OH 43604

Tel: (419) 243-7271 Fax: (419) 243-6418 Toll Free: 800-548-1503

E-Mail: cbt@cityblueprintoftoledo.com

www.PLSO.com

HIGH GRADE HARDWOOD SURVEY STAKES

DELIVERY AVAILABLE

- TOPCON DEALER
- SOKKIA DEALER
- FIELD SUPPLIES
- INSTRUMENT SALES, SERVICE & RENTAL
- GPS TECHNOLOGIES
- FIELD EQUIPMENT



ROBERTS

Surveying Supplies

WWW.ROBERTSSURVEYING.COM

5758 Ridge Road Parma, Ohio 44129

Phone (440) 842-2218

Fax (440) 842-0802

Random Lines

[\(Continued from Page 8\)](#)

and Geodetic Survey Department, tests of tapes, 100 feet long, in place of the tedious and necessarily inaccurate method of comparing with the standard yard in the custody of our County Auditor. It is quite probable that if Mr. Burgess had not been among us, we would have learned to do this, but-but-it is also probable that some other person would have learned what lightning is if Franklin had not gone kiting. It is, of course, true that strain and temperature apply to chains as well as tapes, but their other inaccuracies are so great that to have considered these would have been an absurdity.

There were others who contributed to this improvement: one was, Chas. A. Walter, the assistant, who had charge of Street Surveys under Chas. H. Strong until Walter's death in 1887. He strove to set a good example in accurate work, and more than this, during his official life, the power was placed in his hands to enforce better work in making subdivisions. See Rev. S. of Ohio, Sec. 2601, and Rev. Ordinances of City of Cleveland, 1890, Sec. 1076, page 363. Previous to these enactments there had been some vague requirements as to what a subdivision map should show, but there was no tribunal to determine whether they conformed with the requirements. There are maps on record, made by land owners without the work of a surveyor; to this I do not object, but that is another matter. Under these State and City laws, the City Engineer was upheld in demanding better work, and the standard of work in general was raised."

More from Mr. Varney in future issues. The paper this came from also included some very interesting discussion by some of Varney's peers, some of whom took issue with some of Varney's statements. This will also be some interesting reading.

John E. Dailey. Past
jdailey@sbcglobal.net

www.PLSO.com

**May 7**

Speakers: Mark Yeager, P.S. and Marty Rowe

Mark is the **2008 PLSO Member of the Year**, Cleveland Chapter's 2005 Surveyor of the Year and 2004 President. Mark is the Director of Surveying at KS Associates, Inc. in Elyria, Ohio being employed there since 1996. With more than 24 years of land surveying experience, he has been involved with many large and interesting surveying projects. Mark is also a member of ACSM, NSPS, GLIS and a corresponding member of the Maryland Society of Surveyors.

Marty is the GIS Manger for the Lorain County Auditor's office.

Topic: Lorain County's Geodetic Monumentation System. Over the past 10 years Lorain County has installed, observed, and adjusted nearly 600 geodetic monuments, most of which have been installed by Mark Yeager's survey group. Come hear about this Monumentation system and how it relates to Lorain County's GIS.

PLSO Members \$35.00 Non-Members \$60.00

March CPD Seminar Review

Our own notorious and very extinguished John Dailey, P.S. presented one of his professional seminars to 26 of our members on March 5th entitled "Due Diligence from the Surveyor's Perspective." Now semi-retired, John lectures on the continuing education circuit at much more expensive seminars (such a deal! for PLSO members who earned 1½ PDH's).

Since so many experienced and eminent surveyors were present in the audience, the subject quickly shifted to a lively discussion of:

Mortgage Location Surveys – They are for the lender only, and for a very specific purpose (foreclosure), and should not be released to other parties.

Easements – Visual indications such as pipeline markers, manholes, overhead wires, etc. should not be overlooked. Party chiefs should actually walk the property lines, and keep their eyes open.



Peter D. Zwick
Past President



What is the standard of practice in regard to showing all easements on every boundary survey? Each attendee seemed to be operating under differing standards, and various opinions were voiced.

Take the opportunity to "teach" or to educate attorneys and title company reps as the opportunities arise – This is good for the profession.

ALTA Table "A" Items are optional because there should be an additional fee for each additional item. John recommended that they be priced according to their value to the client (not necessarily per hourly rates).

Certifications – Do not certify any non-ALTA language, and especially do not certify anything outside the realm of professional surveying (e.g. Wetlands, hazardous waste, soil, etc.).

All those present appreciated John's retrospectives, interesting anecdotes and professional insights.

Things I Wonder About.... Boundary Surveys & Easements

By Mike Straub, PS

I think I'm finally old enough to realize the questions I have are what a number of other surveyors have as well. I'm not nearly as embarrassed as I used to be to ask about things of which I have little knowledge. It's not that I'm proud of my ignorance, it's just that I simply want to know a bit more. I hope you do too.

At our last Cleveland Chapter CPD Dinner Meeting/Seminar in early March, John Dailey gave a thoughtful presentation on due diligence during the course of surveys. John showed several examples, including ALTA/ACSM Land Title Surveys, Boundaries, and Mortgage Location Surveys. With the first example being ALTAs, my mind began to wonder. I guess the presentation, being immediately after dinner, was "food for thought". ;-) OK, all groans aside, those of you that were able to make it to the session heard me ask, as much to the audience as to John, "What do you include on your boundary survey maps with regard to easements?"

I re-visit that question here. For a typical lot survey:

Do you typically show the standard front/side/rear utility easement(s) as depicted on a subdivision plat when you do a lot survey?

Do you include easements not recorded with the deed, such as those found in a title report?

Do you include any "CYA" disclaimer statements with regard to title report items being shown or not being shown?

Example: Say you have the following situation – *50 year old subdivision, ditch along sidelines of Sublots A & B with 10' easement, 40 years ago City decides to enclose ditch with box culvert, obtains easement of additional 15 feet on each side, and has easements recorded for both sublots.* You are hired to do a boundary survey of Lot A for a recent purchaser. Are you obligated as a Professional Surveyor to find and show this additional 15' easement? What if you do not, and said purchaser makes landscaping and/or fencing improvements in the easement area? Hmmmm.....

For what are we liable - for not showing?

At the dinner meeting/seminar, it was interesting to hear the responses in the room. Sorry if you missed it.

What did I learn? It's time to read 4733-37 again, time to look at my disclaimer statements, and, once again, time to revisit my standard contracts.

Boundary surveys and easements... just one of the things I wonder about.

Mike Straub, PS
MikeS@StraubSurveying.com



Michael A. Straub
President-Elect

Mark your calendars for the Cleveland Chapter golf outing... Friday June 26th.

Registration form will appear in the next newsletter and will soon be available on plso.com as a hyperlink in its position on the [Chapter Calendar](#).



Precision Laser & Instrument, Inc.

WWW.LASERINST.COM



**24 Month 0% Interest
Financing Available**



CLEVELAND
888-714-GPS3
CINCINNATI
888-714-GPS2
COLUMBUS
800-714-GPS1
PITTSBURGH
724-266-1600

2011 PLSO Annual Conference

Hosted by the Cleveland Chapter

Wednesday, February 9th through Saturday, February 12th, 2011

Planning is already under way for the next conference in Cleveland. Because of the size of the annual conference the locations have become limited to three of the larger Ohio cities. Columbus, Cincinnati and Cleveland. Our Chapter has good reason to accept this responsibility on a three year rotation. The most important benefit is to our Chapter Members who can attend without the added expense of travel and hotel accommodations. No matter what the state of the economy, that's a bonus!



John G. Hoy, P.S.
2011 Conference
Chairman

Also, the Cleveland Chapter is starting its own Scholarship Program and the conference profits are a source of funding. When the conference generates a profit in excess of \$6,000.00 the Chapter is guaranteed a \$3,000.00 share. Every three years that \$3,000.00 is earmarked for the Cleveland Chapter Scholarship Fund. Other earmarks include proceeds from seminars and data bank information. The fund was started in 2008 and as of the end of February contains \$3,417.37. You can make a donation directly by contacting our [Treasurer](#).

The 2009 conference in Columbus is reporting a successful turnout of over 400 attendees. They fell short on the guaranteed hotel rooms but are predicting a profit. Two experiments were integrated into this conference. For the first time, the Conference Banquet was an optional event. This revealed a true indication of the level of interest this event holds for the attendees. 60 out of over 400 attended the banquet. Complete statistics for the 2009 conference are not available yet but in 2008 there were 14 banquet tickets paid by the conference. A reasonable determination then is that less than 14% of the conference attendees were interested in the banquet and willing to pay the additional \$70.00 ticket price. The other experiment was holding two auctions at an event Thursday evening in the exhibit hall. One benefited the Political Action Committee Fund (PAC) and the other to benefit the State PLSO Scholarship Fund. Both successfully generated about \$2,100.00 for each fund. The items auctioned ranged from antique instruments and rare books to vacation getaway packages. A great social event.

Presently the planning stage concerns hotel selection but quickly we'll move into the program, speakers, events, dates and time. Now is your opportunity to be asking questions and making suggestions.

How many CPD credits should we plan? Is Saturday necessary?

Does the spouse program generate enough interest to keep?

What about 3 early-bird CPD credits Wednesday evening from 6-9:30 for special pre-registrants?

Do we eliminate the banquet and find a different venue for the installation of officers and awards?

Is there enough social time? Are lunches and breaks too long?

Can we work with the Visitor's Bureau to provide incentives for attendees to stay the weekend and visit Cleveland's best attractions?

Please let me know your opinions and ideas. This is our opportunity to reinvent the Annual Conference. Thank you in advance for your support.

John G. Hoy
2011 Conference Chair
jhoy.7419@att.net

Executive Committee Mtg. – January 12, 2009 Office of John R. Hoy & Assoc.

In attendance: Jack Hoy, John Dailey, Mike Ackerman, Eric Short and all officers except Chuck Flanigan and Bob Papotto.

Meeting called to order at 6:00 P.M.

Secretary's minutes: Executive Committee meeting minutes from November accepted as submitted.

Chapter Delegate: Alternate Delegate George Hofmann gave an oral report of the January 9, 2009 State Executive Committee Meeting. There was not a quorum. Highlights included the surprise presentation of two candidates for the Executive Director position and the announcement of Mark Yeager as Surveyor of the Year.



Michael Ackerman
Secretary

Treasury: Dave Bruckner submitted written reports for November and December, accepted subject to review. **MOTION PASSED** to donate \$500 to University of Akron for the national student survey competition with a verbal explanation by the Chapter President to Mike Besch that in the future we will be funding our scholarship program in lieu of this donation.

Communication: Robert Hoy - the next deadline for the CSN is 1/13/2009. Bob reviewed the 2009 advertisers. John Dailey mentioned that Toledo-area CSN readers commented to him on how much they liked the newsletter.

Education: No report.

Membership: Ryan Snezak and Jarrod Schnell have joined the Chapter.

Program: George Hofmann reminded all that Tony K's in Berea will be the site of the Cleveland Chapter Annual Meeting on January 22. Cost will be \$25/person.

Scholarship Committee: No report.

Teller's Committee: President Zwick gave the results of the recent election. **MOTION PASSED** to recycle the ballots.

Old Business: President Zwick gave kudos for to the Ex Comm for all that was accomplished in 2008.

New Business: John Dailey reported he is working with a group working on the history of surveying in the county. Bob Hoy is working on the 2009 Chapter calendar.

Meeting adjourned at 7:51 P.M.

Data Bank Survey Discs

1st Scan - Donation: \$100.00

Approximately 7,000 survey TIFF files on a CD.

2nd Scan - Donation \$25.00

Approximately 3,000 survey files in TIFF format on 1 DVD or 4 CDs (Please specify disc format when ordering.)

All proceeds of these donations will go towards the scholarship endeavors the Chapter has recently embarked upon.

Note: These items can be purchased only by PLSO members, must be picked up at Chapter meetings only, and must be ordered in advance.

8 members have already received or requested theirs.
Request yours today!

Look for a brief Data Bank history write up in the next newsletter.

Information and ordering contact:
Robert Hoy 216-389-7677
k666@cox.net

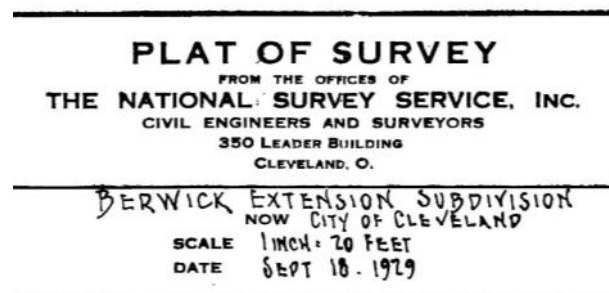



Robert Hoy
Communication
Trustee

The half page advertiser I mentioned last month has decided to not run their ad in the **Cleveland Surveying News**. I hope they will come back when the economic situation improves. In the meantime, our distribution list continues to grow. I have also modified the postcard sent to members without email to be a mini meeting announcement with contact information instead of just stating the newsletter is available on our website.

Our executive committee approved the start of a new publication that will be sent to building departments of cities and villages in Cuyahoga County and select municipalities in Lorain County. The tentative name will be called "Cleveland Land Surveyor". The purpose of this publication is to make building department aware of professional surveyors and to help them understand the difference between different types of surveys. If building departments are more aware of the importance of knowing where property lines lie, the more likely they will be to

suggest, recommend, or require boundary surveys to be performed before issuing fence and building permits.

It's become clear that we professional surveyors need to do a better job promoting our profession in this ever changing technological environment we are in. GIS and GPS are two good examples of surveying technology misinterpreted in the hands of the non-surveying community and home owners. It is our responsibility to protect the public against harm. If we don't bring ourselves to the forefront, we will get passed by.

Chapter Historian Report

Somehow or another, while I was sitting around doing other things, an "opportunity" dropped into my lap that I could hardly ignore. The Chapter leadership put me in contact with William C. Barrow, the Special Collections Librarian at the Cleveland State University Library. Barrow is the man behind the "Cleveland Memories" project which is one of the best sites for Cleveland history. (Featured on Page 2 of [CSN March 2008](#)) He is trying to update the history of surveying in Cuyahoga County and in Northeast Ohio.

There is a small group currently working on Euclid Township, attempting to overlay some of the original 1797 and 1802 surveys on a GIS. I have spoken with Barrow about this and am still having a hard time picking up a useful thread.



John E. Dailey
Chapter Historian

Bill Barrow, Jack Hoy and I had lunch and discussed where he wants to go and how the Surveyors in the area could be of help. We discussed a first step, namely identifying who the early surveyors were, approximately when they were here and where they were working. At the last CPD meeting, I put out a request for anyone who could identify an old time surveyor to get the name and approximate time frame to me. This would serve as a basic data base on which to build. Having these names could lead to finding the actual surveys. How well the surveys will fit together is yet to be determined.

A good place to start would probably be the names of the surveyors who did the original internal subdivisions of the five mile square townships laid out by the Connecticut WR Land Company. On top of this we can start building a survey history. When you are looking over old survey records, look to see who did it and when. This includes plats, deeds or any other document.

If you find some information, please contact me.

John Dailey, Past
jdailey@sbcglobal.net
440-888-1930

The National Geodetic Survey (NGS) now has an interactive mapping tool for CORS (continually operating reference station) that they have accepted. This mapping interface is integrated with *Google Maps* shown at right.

Graphically selecting a CORS pin location brings up a web page for the station which includes ability to select a time frame of data from it to download.

You can find this map here:

www.ngs.noaa.gov/CORS

Hopefully NGS will also update its *Map Viewer* for its geodetic monuments also. Currently their map viewer is difficult to use because the map does not display road names or cities and the monument markers are non-interactive.

Until they update your map, you can use <http://benchmarks.scaredycatfilms.com/OH.html> that was featured on Page 11 of [CSN Sept 2007](#).

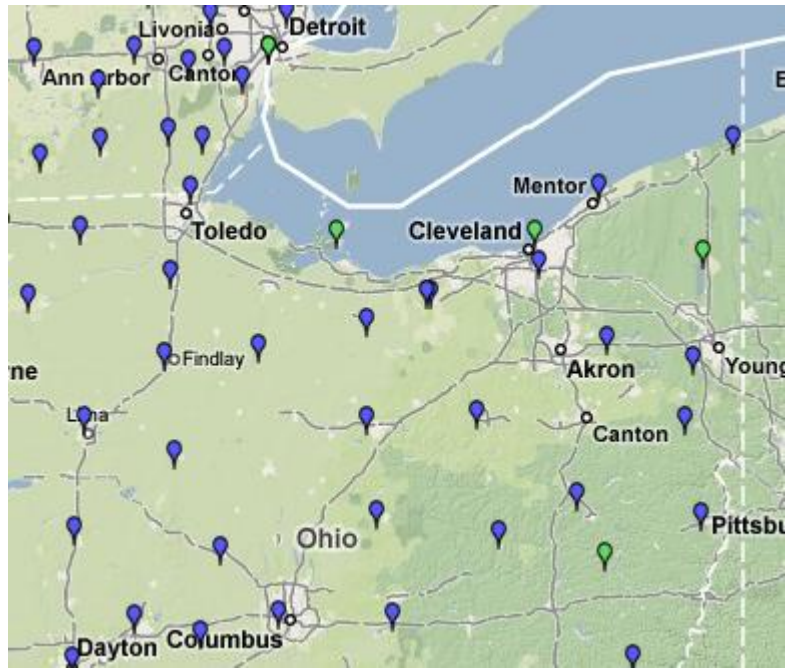

Executive Meeting Highlights

Highlights of the March 16th executive committee meeting, office of John R. Hoy & Associates

In attendance: John Dailey, John Hoy, and all officers except Chuck Flanigan and Bob Papotto.

Treasury: John Bischof submitted written reports for January and February 2009. A new scholarship fund has been created using funds from data banks sales and the conference.

Mike Straub proposed sending a press release to Crain's Business News about the 2009 chapter officers.

John Hoy updated the status of the 2011 Conference. The search for a feasible location continues. The number of credits to offer and length of the conference was discussed.

Eric Short reminded all of the next meeting offering CPD credit on April 2, 2009. Registration for the meeting has been filled.

Moved the location of the April 20, 2009 Executive Meeting to Parma City Hall.



PLSO Executive Committee Meeting Friday March 13, 2009
Meeting call to order 6:02 P.M.



George Hofmann
Delegate

- 1.2 Introduction of Melinda Gilpin , Executive Director started March 9,2009
- 2.0 Secretary's meeting for November 2008 were accepted Minutes for September, 2008 and January 2009 still to be submitted.
- 3.0 Treasurers report not complete
- 4.1 No report, keeping an eye open for future development.
- 4.3 No report
- 4.4 Website proposal, Melinda to meet with Paul Dinan
- 4.5 All motions from January were ratified.
- 4.6 Soil scientist, State Board met Jan. 21, 2009 PLSO made presentation to state board. Board was unaware of who were actually preparing maps. They have opened three investigations.
- 4.7 Nothing to report will keep watch.
- 5.1 New Members, 1 professional, 1 associate, 1 affiliate, 5 student, Motion Passed.
- 5.2 National Surveyors Week, March 15 –21, 2009. Sample press release prepared by Melinda Gilpin, she would like to see all chapters get this circulated in their area.
- 5.3 President Dean Frederick would like to establish a Historic review committee.
- 5.4 Tom Silva has been appointed to replace Bob Ernsberger.
- 5.5 Rose Coors reported that the Southwestern Chapter would like to pursue legislation to establish statewide statute of limitations for Professional Surveyor licensed in the State of Ohio. They have a local attorney who has offered his services at no charge. They are not asking for any financial support. The Executive committee authorize her to move forward on this proposal and report back on its progress.
- 6.1 CEAO is offering seminars, see their website.
- 6.2 ODOT has received letter from Timothy Riley, Surveyor regarding covering monuments. Referred to Standards committee. Looking for input from chapters.
- 6.3 Paul Dinan reported that license renewals were sent out to 1453 PS, and 804 Dual Registrants.
- 7.11 Balance Feb \$3,514.85
- 7.13 Dean Ringle is looking for volunteers. Contact him for where and when.
- 7.2 Don Friedmoth had quintuple bypass and carotid artery surgery. Recovery is going well.
- 7.31 Pat Leonhardt will take over as chairman, would like more chapters involved, try to tie in with National Surveyors Week.
- 7.32 CST can be taken on computer, proctor needed (must be a disinterested person)
- 7.41 2009 Columbus convention made profit, final numbers to follow. Over 400 attendees. Took a big loss on rooms. Suggests that Friday banquet not be optional.
- 2010 Will be held at Cincinnati Netherlands Hilton 2/11-2/12
- 2011 George Hofmann reported that the conference is registered with the Cleveland convention & visitors bureau and that information from them is expected back by the end of April and chairman John G. Hoy expects to recommend a hotel by June 1, 2009. He also asked Barb Jones about the information requested by John. Barb said she was unsure of how to respond to some of the inquiries. Bud Payne said he would contact John and asked that John co-ordinate everything with Melinda Gilpin.
- 8.0 President Dean Frederick stated that this year there will be no such thing as no report from a chapter delegate. All delegates in attendance had either a written report submitted or gave an oral report.
- 10.0 Executive Director Melinda Gilpin passed out a Federal stimulus resource sheet
- 11.0 President Dean Frederick suggested that the October meeting be held at the Fall Seminar. To be further discussed at the April meeting



Robert Hoy, P.S.
CSN Editor

The 4th and final part of my 4 part review of northeast Ohio county GIS's. I am finishing this project in March when I initially envisioned including reviews of all 6 area GIS's in the December 2008 CSN. Go figure.



atop the next column. These parcel labels will not become visible until you are sufficiently zoomed in. There are also layers to show old parcel lines, lot lines, and tracts. All of which are very useful options for surveyors. Also text displayed on the mapping stays the same size no matter how far you zoom in.

Layers

I have already discussed a portion of the layers the Lake GIS has available and they are displayed to the left of the mapping. The GIS offers layers for contours, streams, soils, and draft updated flood maps that are found under the *Elevations*, *Hydrography*, and *Environmental* layer folders respectively.

Geauga provides aerial photography dating back to 1973. Yes 1973, it's not a misprint. The resolution and edge matchup for the older aerials certainly isn't as good as photography flown since the year 2000, but it is still very useful. When you are doing land planning for the future, it's important to know how the land was in the past. The Lake GIS department plans to add aerial photography from 1951 very soon. They are also working on photography from 1967 and 1937; however, the completeness of county coverage is lacking and extra funding is necessary to bring it all to the GIS.

You will notice the Lake GIS has aerial photography layers for Ashtabula, Geauga, and Cuyahoga counties. This is for emergency management functions because Perry nuclear power plant is within Lake County. Cuyahoga's aerials and centerlines were hosted for the benefit of Cuyahoga's emergency management teams before Cuyahoga had their GIS operating.

[\(Continued on Page 20\)](#)

Lake County

The Lake County GIS is governed by the GIS Board, County Engineer, County Auditor, and County Commissioner. Lake GIS logged 42 million hits in 2007. Their GIS was started in 1999 and was the first ArcIMS Internet GIS application in Ohio back in 2000. They update the tax map daily.

The start page of the Lake GIS is:

www.lakegis.org

You can launch the mapping window at the upper right corner by clicking on this feature.



Navigation

The Lake GIS uses the same general interface the Summit GIS offers. The navigation buttons shown above right in order are: zoom in, zoom out, pan, previous map view, and view entire county. Your zoom or pan selection remains in effect until you choose another tool. You can zoom to a specific scale by inputting the value at the lower right corner of the GIS window. Their mapping does fully expand if you maximize your browser using a widescreen display. There is also real-time geodetic positions at the bottom of the screen.



Tax/Parcel Map

The Lake GIS allows for view of a Parcel Map (parcel lines only) or the full tax map by turning additional layers on. Click on the *Parcel Labels* folder in the layers palette shown at right to get the additional parcel text layer options. The mapping with parcel numbers, owners, and lot dimensions is shown

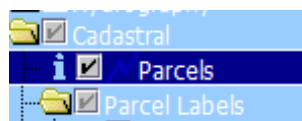

Autodesk Technology. Avatech Expertise. Better Results.

- Consulting
- Implementation
- Surveying Technologies
- Training and Technical Support
- Software and Custom Development



Technology for the World You Build

- Increase production without additional staff
- Reduce cost, rework, redundancies, and errors
- Proven results to increase your bottom line

What can our solutions do for you?

Call our Cleveland office at **877-717-5600** to find out more.

Leica
Geosystems



AVATECH
SOLUTIONS®

Altogether Smarter Design.

Autodesk®

Authorized Value Added Reseller

www.avatech.com

[\(Continued from Page 20\)](#)

[Lake County]

Three other tools that I haven't seen in the other 5 GIS's are shown at right and have these functions:



- Button 1: line or outline an area on the map in a specified color
- Button 2: label GIS data field (e.g. owner, road name, address) in adjustable sizes, fonts, etc.
- Button 3: state plan queries.

Downloads

The Lake GIS does not have any directly GIS related downloads available. They do sell GIS data on CDs for \$50.

The Lake County Tax Map Department has an archive of surveys, railroad valuation maps, and old atlases found here:

www.lakegis.org/TaxMap/SURVEYS.htm

When in either *survey* selection, click on the option for *TIF* directory when confronted with the "To Parent Directory" screen.

The Lake County Engineer has a link for *Road Records* in his *Survey Data* page found here:

www.lakecountyohio.org/engineer/Survey.htm

However the links on this page are not working at this time. I've searched their road records before and many of them are scanned field book pages of county surveys.

Monumentation

Click the box next to *Control Points* in the layers

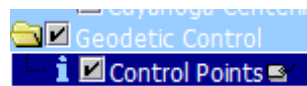

list as shown at right to turn on Geodetic Monuments on the mapping. Then click on the words "Control Points". This will add the blue "i" making it your *Active Layer*. Next click the "i" button shown at right to allow you to graphically identify a feature. You can finally graphically select a geodetic monument marker and data for it will appear at the bottom of the screen. There will include a link to a PDF data sheet for it under the *Number* column. Some of the data sheets include a ground level photograph of the monument's surroundings and an aerial photograph.



Printing

This is where Lake GIS really shines and gives

users useful options. By clicking the printer icon/button at the top left of the screen, you are then given options to create a map at a specified scale, to include auditor's or recorder's information if a parcel is selected, and control over print size and orientation! You are able to create a print PDF in three sizes: letter, ledger (11x17), and 20x36 which they call *Tax Map* and in both portrait and landscape orientations! I can't tell you how good a feature this is to have when other GIS's only provide a user with a letter sized portrait print page.

In conclusion, it is obvious the longer a GIS has been around the more features it can offer. The Lake GIS excels at parcel label layers and print options. There is also very good access to county surveys and road records. This makes me wish I had more work to do in Lake County.

All 6 GIS reviews are now complete, so what have I learned? A considerable amount that's for sure. The newest GIS, Cuyahoga, has a bit of catching up to do to its older surrounding counties. I have high hopes for Cuyahoga's GIS to grow and add features and information.

It has been a very good experience to engage the GIS administrators from these 6 counties to show how we surveyors use a GIS and what is important to us. Starting next month I will have a place in the newsletter for GIS updates.

I would again like to thank the individuals that provided information and answered my questions during this review time. You can click on their name below to send them an email.

Lorain County

[Marty Rowe](#), GIS Manager

Summit County

[Jeffery M. Mallison, P.S.](#), Summit County Fiscal Office GIS

Medina County

[Lowell Filak](#), Computer Operations Supervisor

Cuyahoga County

[J. Kevin Kelley](#), Information Technology Administrator

Lake County:

[Dick Kotapish](#), GIS Director

Robert Hoy, P.S.
CSN Editor

2009 Cleveland Chapter Calendar

April 2

April 17

April 20

April 22

Seminar Meeting

State Executive Committee Meeting

Executive Committee Meeting

Cleveland Surveying News Deadline

Executive Committee Meetings

are held at:

Parma City Hall

at 6pm and are open to all Chapter members who want to attend.

May 7

May 15

May 18

May 20

Seminar Meeting

State Executive Committee Meeting

Executive Committee Meeting

Cleveland Surveying News Deadline

June 4

June 26

General Membership Meeting

William J. Haas Memorial Annual Golf Tournament

July 10

State Executive Committee Meeting

August 10

August 12

Executive Committee Meeting

Cleveland Surveying News Deadline

September 3

September 11

September 14

September 16

Seminar Meeting

State Executive Committee Meeting

Executive Committee Meeting

Cleveland Surveying News Deadline

October 1

October 8-9

October 16

October 19

October 21

Seminar Meeting

PLSO Fall Seminar, Youngstown Holiday Inn

State Executive Committee Meeting

Executive Committee Meeting

Cleveland Surveying News Deadline

November 5

November 13

November 16

Seminar Meeting

State Executive Committee Meeting

Executive Committee Meeting

December 11

December 14

State Executive Committee Meeting (if needed)

Executive Committee Meeting (if needed)

January 8

January 11

January 12

January 21

State Executive Committee Meeting

Executive Committee Meeting

Cleveland Surveying News Deadline

Annual Meeting