

# Cleveland Surveying News

September 2008



## In This Issue:

- Fall Technician Workshop details!
- Ohio Surveying News is now Online!
- [New](#) Lorain County Flood Zone Maps



**Cleveland**  
**Chapter of PLSO**

Publication of the Cleveland Chapter of  
the Professional Land Surveyors of Ohio

Circulation: 207 issues

Editor & Photographer: Robert Hoy, P.S.

MAILING ADDRESS:

**P. O. Box 81713**

**Cleveland, OH 44181-0713**

#### 2008 Advertising Rates:

**One-sixth page:** 3"h x 3.6"w \$80 yr.  
**One-half page:** 4.5"h x 7.5w \$200 yr.  
**Full page:** \$400 yr.  
 Single Issue Full Page: \$100

Help Wanted or Position Wanted up to  
one-half page is \$30.00 per issue.

Contact: Robert Hoy, [k666@cox.net](mailto:k666@cox.net)



On the cover: Kettle Corn at the Johnny  
Appleseed Festival at Mapleside Farms  
Photo: © John Hoy 2008

#### ADVERTISER INDEX

- 4 [Aerocon Photogrammetry](#)
- 6 [Avatech Solutions](#)
- 7 [Roberts Surveying Supplies](#)
- 9 [City Blueprint of Toledo](#)
- 10 [Imaginit Technologies](#)
- 12 [Jake's Stakes](#)
- 15 [Leica Geosystems](#)

## Contents

### Features

<a href="#">Fall Technician Workshop</a>	5
<a href="#">Canal Map Scans</a>	8
<a href="#">Lorain County Flood Maps</a>	12

### Reports

<a href="#">President's Message</a>	3
<a href="#">President Elect's Message</a>	3
<a href="#">Delegate</a>	10
<a href="#">Communication</a>	14
<a href="#">Delegate's Attachments</a>	18

### Meetings

<a href="#">October CPD Seminar</a>	4
<a href="#">September 4th Meeting Review</a>	16
<a href="#">Executive Committee Review</a>	17

### Articles

<a href="#">John Dailey - Random Lines</a>	7
<a href="#">Have you ever seen a column line move?</a>	13

### Miscellaneous

<a href="#">Survey Discs</a>	8
<a href="#">Calendar</a>	16
<a href="#">Secret Society... S<sup>4</sup></a>	17

### Editor's Message

I'd like to take the time to showcase on-line features of the Cleveland Surveying News PDF files and our website.

Every email address in this document is a hyperlink. Click on an address and it will bring up your default email program with a new message having the To: and Subject: lines already filled out accordingly. This includes the officers' email addresses listed below that may appear very small and difficult to read.

If you only use our website, [www.plso.com](http://www.plso.com), for reading the newsletter I recommend you see what else it has. The [About the Chapter](#) page has a Chapter history along with a full list of past Presidents and Surveyor of the Year recipients. The [Contact Us](#) page has officer photos so you'll know who we are at Chapter meetings, along with the Chapter Constitution and Officer Handbook available for downloading. There's even ways to nominate Chapter members for awards and officer positions.

Robert Krause has put together a top notch Chapter website and I hope you get the use out of it that I do. It's a great source to direct possible new PLSO members to.

Robert Hoy  
CSN Editor

### 2008 Executive Committee

#### President

Peter D. Zwick  
[zwick@eng.ohiocoxmail.com](mailto:zwick@eng.ohiocoxmail.com)  
440-235-2729

#### President Elect

Timothy Feller  
[timf@mcsteen.com](mailto:timf@mcsteen.com)  
440-585-9800

#### Past President

John J. Bischof  
[bischof@cvelimited.com](mailto:bischof@cvelimited.com)  
440-439-1999

#### Treasurer

David J. Bruckner  
[dbruckner@city.cleveland.oh.us](mailto:dbruckner@city.cleveland.oh.us)  
216-664-2462

#### Secretary

Michael A. Straub  
[mikes@straubsurveying.com](mailto:mikes@straubsurveying.com)  
440-333-1700

#### Chapter Delegate

John G. Hoy  
[jhoy.7419@att.net](mailto:jhoy.7419@att.net)  
216-476-3600

#### Communication

Robert G. Hoy  
[k666@cox.net](mailto:k666@cox.net)  
216-389-7677

#### Education

Robert A. Papotto  
[bobpapotto@wideopenwest.com](mailto:bobpapotto@wideopenwest.com)  
440-934-7878

#### Membership

Charles W. Flanigan  
[cfpeps@neo.rr.com](mailto:cfpeps@neo.rr.com)  
330-769-4812

#### Program

George A. Hofmann  
[george\\_hm@ameritech.net](mailto:george_hm@ameritech.net)  
440-234-5544



One of our Cleveland members, Kathleen McGervey, P.S., P.E., is something of a celebrity after being interviewed on National Public Radio from the floor of the Republican Convention in Minneapolis. (Audio can be heard at this link starting at 00:36 seconds: <http://www.wcpn.org/index.php/WCPN/news/14242/>) Her remarks were cogent and insightful (despite forgetting to plug PLSO). The point is that it would behoove us surveyors to follow her example and engage the political process, seek appointment to local boards and commissions, and elevate our profession by getting out there and being more visible to the public. Our public image certainly could use the boost, and it's up to us to take it to the next level. Several of our Chapter members have long served as planning commissioners, zoning board members, elected officials and community leaders – we thank them for their service and for their professionalism.



**Peter Zwick**  
**Chapter**  
**President**

Looking beyond the Oct. 2<sup>nd</sup> and Nov. 6<sup>th</sup> CPD dinner meetings, next year we plan to offer the first three seminars on March 5<sup>th</sup>, April 2<sup>nd</sup> and May 7<sup>th</sup> in 2009, so please reserve those dates. At this time, I am not at liberty to leak the particulars, but Tim Feller has lined up some boffo speakers, and we may reprise the very popular Panel Discussion format in May. As far as we know, Cleveland PLSO offers the least expensive PDH's available anywhere, and you get to dine with some great folks in the deal.

Speaking of the 15 PDH's that are required each year, it has recently been reported to PLSO that the State Board of Registration has begun to audit surveyors for compliance with its continuing education regulations. They are looking for certificates to document the minimum number of hours, and are enforcing this quite stringently. Reportedly, they have also charged *falsification* of license renewal application in the cases where certificate documentation is lacking. Disciplinary action is required for these cases, so avoid this situation at all costs. You can earn 2 ½ more hours yet this year by calling Tim Feller before Oct. 2<sup>nd</sup>.

This is the last call for candidates for new Chapter Trustees for 2009. Don't be intimidated by the fancy-sounding title, because we need people just like you to volunteer. Please immediately contact the president, past-president or president-elect if you are interested.

Peter D. Zwick. P.S., P.E.

**President-Elect's Message**

I would like to start off by thanking all of those past and current members of this chapter that have dedicated a portion of their time to see that this chapter not only continues to exist, but also grows. The intent of this organization is not only to give our local surveyors a collective voice in our profession but also to give back to the surveying community. This chapter is one we should all be proud of. I know I never recognized my pride until I actually became involved. Having the opportunity to debate current surveying issues with other members has not only given me new friends but also a wealth of information and confidence when it comes to our profession.



**Timothy Feller**  
**President-Elect**

The key to keeping this chapter moving forward is you! Fortunately there is an opportunity for a rare few to get on board and be on the front line of helping mold the future of our chapter! Call me now 440-585-9800 before you let it get by. Officers of the chapter are entitled to 2 CPD credits per year.

**Thursday October 2, 2008****Marriott Hotel**

4277 West 150th St. Cleveland

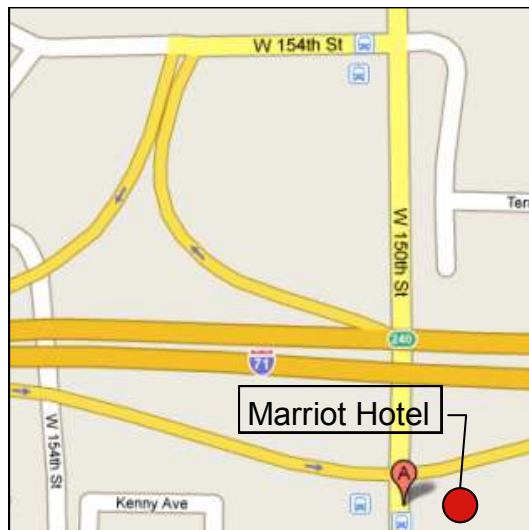
**FREE PARKING**

[Click Here](#) for a full Google Map page for the hotel

**Speaker**

Sergeant Jeff Stanscyk from the Cleveland Police Dept.

**Topic**

"Surveying Precautions in Urban Areas" - 1 CPD Hour

Also, [Paul Dinan](#) & [Dean Frederick](#) (PLSO State President & President-Elect), will attend and give us a perspective from Columbus.

**Schedule**

5:00 - 6:00: Social/Registration

6:00-6:30: Dinner

6:30-7:30: Sergeant Jeff Stanscyk

7:30-8:00 Paul Dinan

**Menu**

Chicken Marsala with vegetable & starch

House Salad, rolls & butter

Coffee, Iced Tea, Herbal Tea

**Reservations**

Contact Tim Feller by Wednesday October 1st:

[timf@mcsteen.com](mailto:timf@mcsteen.com) or 440-585-9800



**Timothy Feller**  
President-Elect

**Price**

Members	\$35.00
Non-Members	\$60.00

# AEROCON

**Aerocon Photogrammetric Services Inc**

*Dedicated to providing quality photogrammetric services since 1967*

- **Aerial Photography**
- **Digital Orthophotography**
- **Digital Topographic Mapping**
- **Analytical Triangulation**
- **DTM/DEM Surface Generation**
- **LiDAR**
- **Airborne GPS**
- **GIS Services**
- **Volumetric Inventories**

4515 Glenbrook Road  
Willoughby, OH 44094-8215  
440.946.6277  
440.946.2646 Fax  
e-mail: [skymap@aerocon.com](mailto:skymap@aerocon.com)  
[www.aerocon.com](http://www.aerocon.com)

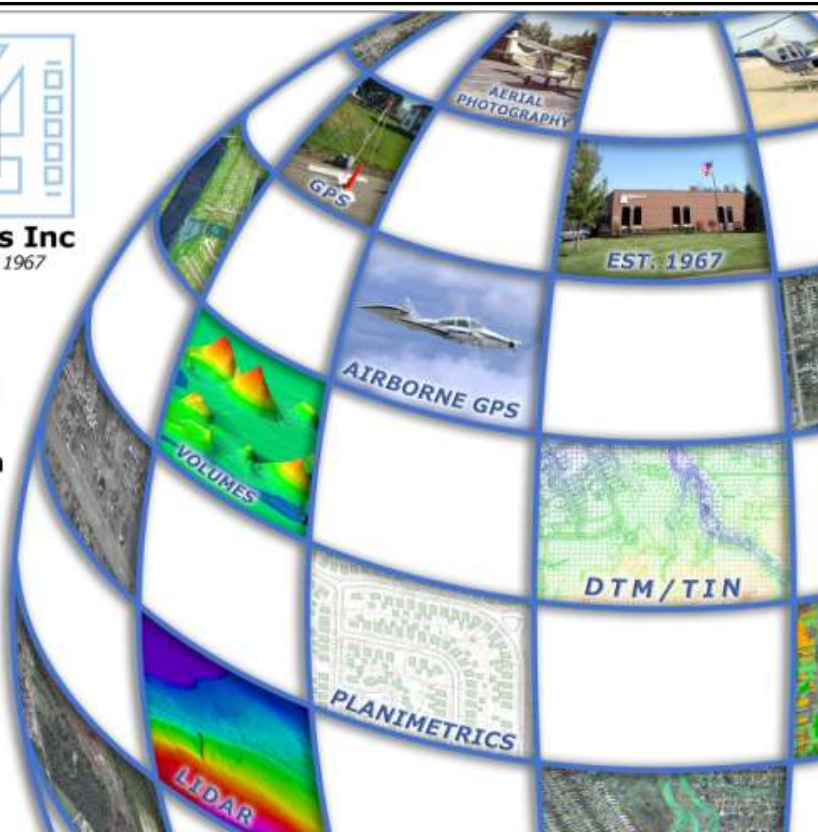

**Topic:** Ohio Utilities Protection Service (OUPS)  
**When:** Monday November 10, 2008  
**Time:** 5:45 to 7:30 p.m.  
**Location:** Cuyahoga County Engineer's classroom facility

What are the benefits of attending this workshop? As survey techs are usually involved in preparing base maps showing existing utility information, this workshop will be an excellent opportunity for them to improve the quality and accuracy of their utility base maps.



**Robert A. Papotto**  
Education Trustee

**Date:** Monday November 10, 2008  
**Time:** 5:45 p.m. to 7:30 p.m. with Pizza and soft drinks at 5:45  
**Location:** Cuyahoga County Engineer's classroom facility, 3<sup>rd</sup> floor  
N.E. corner of W. 25<sup>th</sup> St. & Detroit Ave. accessible from Vermont Ave. in Cleveland  
[Click Here](#) for a Google Map page of the workshop location.  
**Cost:** \$30.00  
**Registration Deadline:** November 5, 2008

### **Workshop Overview:**

Speaker Alice Miller from OUPS will be discussing OUPS Pre-Planning Ticket Procedures.

Topics will include:

- What information is needed by OUPS operators for accurate locations
- Tips from OUPS Operators-common questions
- How to use the new On-Line OUPS system for Pre-Planning information
- Questions

Also a representative from a utility company, possibly First Energy, will make a presentation on how to interpret and translate the information provided from an OUPS Pre-Planning request and how to plot the information as accurately as possible.

---

Print this page, complete the form below, and mail with payment.

(Make checks payable to Cleveland Chapter of PLSO) **Mail To:** Bramhall Engineering & Surveying  
Attn: Bob Papotto - PLSO  
801 Moore Road  
Avon, Ohio 44011

**For further information** call Robert Papotto 440-934-7878

Name: \_\_\_\_\_ Home Phone: \_\_\_\_\_

Name: \_\_\_\_\_ Home Phone: \_\_\_\_\_

Address: \_\_\_\_\_

Employer: \_\_\_\_\_





# Autodesk Technology. Avatech Expertise. Better Results.



- Consulting
- Implementation
- Surveying Technologies
- Training and Technical Support
- Software and Custom Development

## Technology for the World You Build

- Increase production without additional staff
- Reduce cost, rework, redundancies, and errors
- Proven results to increase your bottom line

### What can our solutions do for you?

Call our Cleveland office at **877-717-5600** to find out more.

**Leica**  
Geosystems



**AVATECH**  
SOLUTIONS®

Altogether Smarter Design.

**Autodesk**  
Authorized Value Added Reseller

[www.avatech.com](http://www.avatech.com)

As autumn comes down on us, we have to look around with a great deal of trepidation. The economy is in a shambles, the housing market shows no signs of improving in the near future, conversations with surveyors from all over the country show very few, if any, bright spots. In the March issue of Cleveland Surveying News, I talked about "Weathering Hard Times." Well, the "hard times" are here, folks. Any of us who have been around this business for any length of time have seen all this before. These downturns usually come about every ten to fifteen years, but none quite so severe as this one.



**John E. Dailey**

Where are we headed? I don't know, but I do not think we have hit bottom yet, even with the federal government taking some really drastic steps to slow down the fall. They are gambling that an immediate infusion of cash will give the stock markets and the banks a little breathing room to reorganize and get their businesses back on solid ground. In 1932, Franklin D. Roosevelt had to close the banks for two weeks to forestall a complete collapse. He was vilified as a Socialist but many of the plans he put into effect are protecting us now, such F.D.I.C. that insures the money you have in the bank.

The housing market, especially new homes is stagnant and this is driving down a lot of the economy. I remember standing on a new street with a developer looking at a new home nearing completion. He made the comment that the new house was only the tip of the iceberg. He said "no woman is going to move into a new house with old drapes or old carpets. They will not keep old appliances too long either. Then they will have to change the furniture to look as good as the new house. Then, in a few short

*(Continued on Page 8)*

## HIGH GRADE HARDWOOD SURVEY STAKES

DELIVERY AVAILABLE

- TOPCON DEALER
- SOKKIA DEALER
- FIELD SUPPLIES
- INSTRUMENT SALES, SERVICE & RENTAL
- GPS TECHNOLOGIES
- FIELD EQUIPMENT



# ROBERTS

## *Surveying Supplies*

[WWW.ROBERTSSURVEYING.COM](http://WWW.ROBERTSSURVEYING.COM)

5758 Ridge Road Parma, Ohio 44129

Phone (440) 842-2218

Fax (440) 842-0802

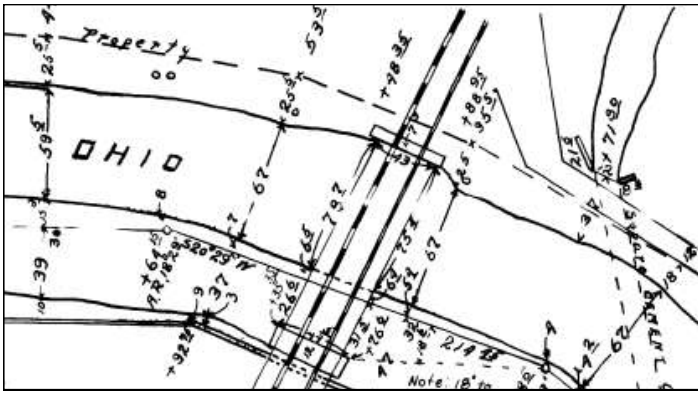

## Survey Discs

1st Scan - Donation: \$100.00

Approximately 7,000 survey files in TIFF format on CD.

2nd Scan - Donation \$25.00

Approximately 3,000 survey files in TIFF format on 1 DVD or 4 CDs (Please specify which disc medium when ordering.)

Both scans come with printed and bound index, provided by William J. Vondra, listing surveys by township then by original lot. All proceeds of these donations will go towards the scholarship endeavors the Chapter has recently embarked upon.

**Note:** These items can be purchased only by PLSO members, must be picked up at Chapter meetings only, and have to be ordered at least 1 week in advance.

For information and ordering contact:

Robert Hoy at 216-389-7677 or [k666@cox.net](mailto:k666@cox.net)

Ever perform surveying along a canal in Ohio? High quality scans are available through the Ohio Department of Natural Resources via this webpage: <http://ohiodnr.com/water/oeplats/tabid/3300/Default.aspx>  
A sample of the canal maps is shown above.

We have Chapter member Trevor Bixler to thank for this information. Keep sending webpage links to the editor so we can all benefit from these additional surveying resources!

Email the CSN Editor: [k666@cox.net](mailto:k666@cox.net)

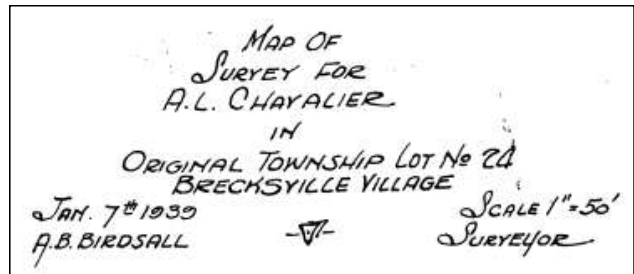

## Random Lines

(Continued from Page 7)

months, they will realize that their old car looks terrible in that brand new garage." The house is only the tip. The housing markets drove an awful lot of other industries, not just construction.

There may be an upside to this downturn/recession. Maybe people will get back in the habit of living within their means and not strictly on credit. They may even remember to save for what they want to buy, not just run for it at full tilt.

In less than 40 days, we will be taking part in a very important election. You haven't heard me talk about this for two years and I know some of you would miss it if I did not say something about it.

We live in a representative democracy that says that we, the people, will choose the representatives who will serve us. I would never tell you how to vote or who to vote for. That is your part of democracy. Our Constitution celebrated its 219<sup>th</sup> birthday on September 18 and maybe we should all take a few minutes to read it and to refresh our memories of what it says. We have the opportunity every two or four years to have our own revolution, but we can do it with ballots, not bullets.

If you do not exercise your right to perform your duty, you have no right to complain about the outcome. This could be the most important election in the past 40 years. Get out and do your duty.

John E. Dailey

Past

e-mail: [jdaileye@sbcglobal.net](mailto:jdaileye@sbcglobal.net)



Your  
Complete  
Source



Sales • Service • Rental • Leasing • Training • Support

 **Trimble**



**SOKKIA**



**SCHONSTEDT**  
INSTRUMENT COMPANY

**Lufkin®**

**GRAIN®**



**ROLATAPE®**  
CORPORATION

**CST**

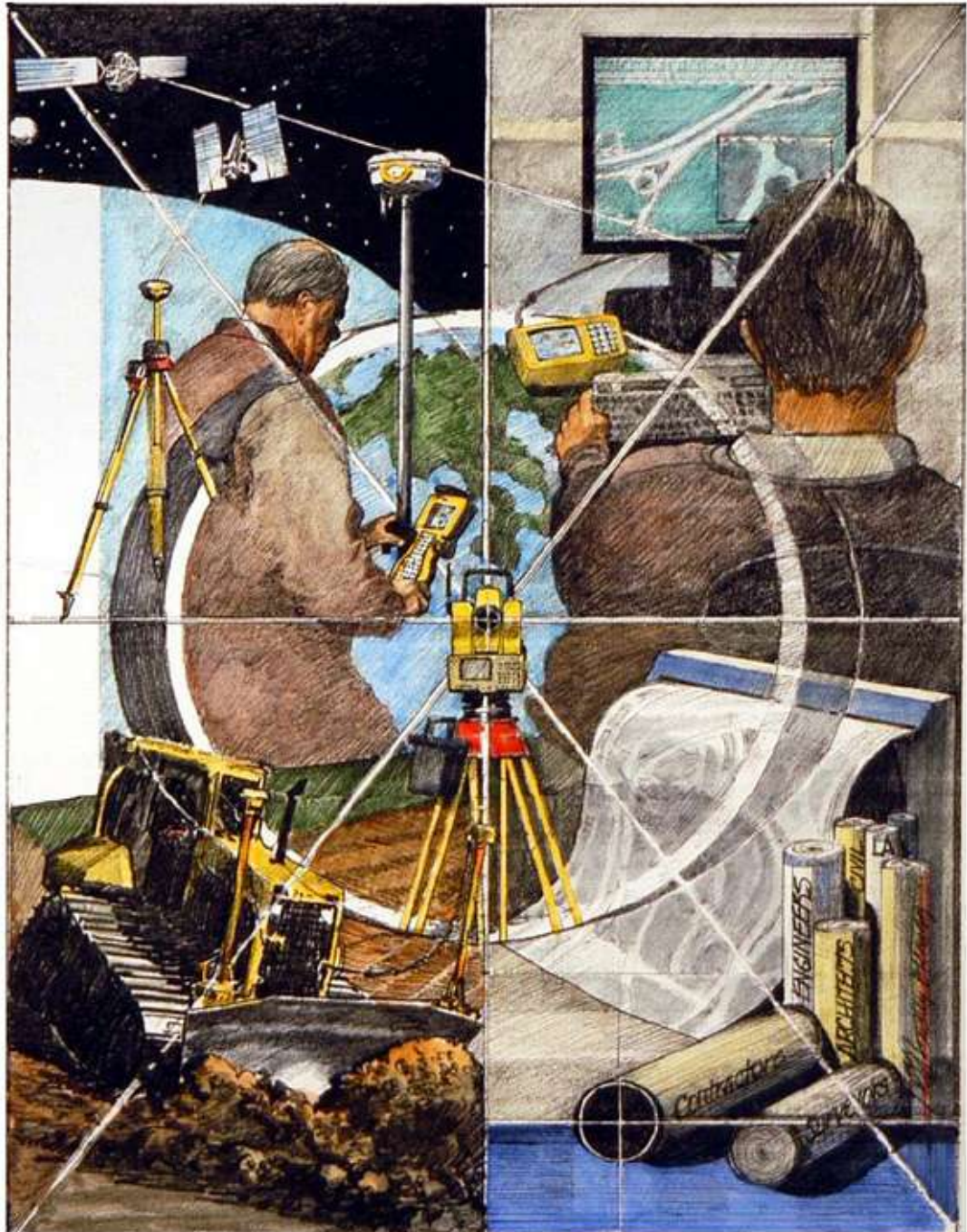

2010 Madison Avenue - Toledo, OH 43604

Tel: (419) 243-7271 Fax: (419) 243-6418 Toll Free: 800-548-1503

E-Mail: [cbt@cityblueprintoftoledo.com](mailto:cbt@cityblueprintoftoledo.com)

Executive Committee Meeting on Friday, September 19, 2008 Call to order: 6:04 p.m. Immediate Past President Brad Kramer was absent recovering from surgery. All other Officers were present. Upon completion of a roll call, determination of a quorum (17), acceptance of the July minutes and Treasurers report the meeting turned to **Unfinished Business**.



**John G. Hoy**  
Delegate

- 4.3 Twenty new *Surveyor of the Past* plaques are being produced.
- 4.4 The Ephraim Brown Land Office project at Hale Farm is complete.
- 4.6 The SHS Rendezvous was successful with 110 in attendance.
- 4.7 Website Upgrade: The "Members Only" section was up on Aug. 23<sup>rd</sup>. Some three hundred emails notifying members of the news bounced back as undeliverable. The next proposed upgrade is to allow voting capability. The setup cost was \$400 for the entire state and an additional \$200 for all the chapters to have individual voting capability. The voting could be for ballots, online surveys/questionnaires or other uses. I made a motion to spend the \$600 to keep the upgrades moving forward but it was tabled until the October meeting to obtain a better description of the capability from the vendor. As crude as it sounds, some chapters elect their officers at a general membership meeting. If you don't attend the meeting, you don't get to vote. Spending the extra \$200 was questioned as a waste of PLSO funds. Setup fees for possible future upgrades include: capability for online payments/registration for conferences-seminars \$400 and online payment of dues \$300. These setup fees for online payments do not include bank and/or processing fees.

#### **New Business**

- 5.1 Acceptance of new members, Richard A. Stacko of Parma was added as an Associate Member to the Cleveland Chapter.
- 5.2 Nominations for PLSO Officers will be open for another month.
- 5.3 The Committee entered into **Executive Session** to discuss personnel issues from 6:45 until 8:19.

*(Continued on Page 12)*



Your software has changed.

Your clients have new demands.

Have you kept up?

**Your CAD software should support your business goals and meet your design needs.** We can help you fit your Autodesk Civil 3D, Land Desktop and Map 3D software to your workflow – and free up your time to do more surveying and less drafting.

**We've been your source for Autodesk Surveying, Civil Engineering and GIS software for over 20 years** – the right tools for every size survey, mapping and land development project.

**Turn to us for the training, implementation and technical support services that keep you productive.**

**Challenge us – tell us one thing you don't like about your software – and see if we can show you a better way.**

**Offices throughout Ohio**

Phone: 216.834.8326

Web: [www.rand.com/IMAGINiT](http://www.rand.com/IMAGINiT)

Email/info: [LHorowitz@rand.com](mailto:LHorowitz@rand.com)



[\*\(Continued from Page 11\)\*](#)

#### Inter-Association Delegates

- 6.3 The State Board of Registration. A public meeting is set for Monday, September 22, 2008 at 3:00 p.m. to discuss the proposed changes to surveying and engineering laws. The spring 2008 surveying exams: Fundamentals – 20 of 29 passed the exam, professional – 3 of 12 passed the exam.

#### Committee Reports

Political Action Committee: Balance in the fund is \$1,759.85.

- 7.12 The Standards Committee submitted proposed changes to 4733-37-05 and –06 requesting that chapters review the proposal and return comments to the October meeting. [\*\(Attachment Page 18\)\*](#)
- 7.14 PLSO Vision Committee: Rose Coors submitted a draft report dated 9/4/08 requesting that chapters review the proposal and return comments to the October meeting. [\*\(Attachment Page 21\)\*](#)
- 7.15 Executive Director Search Committee: Frank Snyder reported that the first and only meeting of the committee was held earlier today. The committee consulted the Constitution, By-Laws, Employee Handbook, Duty lists, Draft of the Vision Committee Report and the advertisement used in 1995 to discern the following steps to be followed to replace the Executive Director:
- Run an ad in the Columbus Dispatch and possibly in web-based employment sites.
  - Send a letter of interest to the best respondents with the duties/expectations of the position and arrange interviews before the three committee members.
  - Secure the services of the Executive Director of Michigan (A non-licensed individual) to either attend/preside at the interviews or provide the committee with the questions to use during the interviews.
  - Narrow the field to a single candidate and schedule the second interview either at the next available Executive Committee meeting or at a special Executive Committee meeting.
  - Immediately following the interview request a motion to hire the candidate.
- 7.2 Newsletter Editor Report: Barb Jones reported that Issue 3 is being assembled. Deadline for Issue 4 is November 1, 2008.
- 7.3 Mike Besch reported that next week is the NSPS “Lobbying Week” in Washington. He will be unable to attend and is looking for someone to attend in his place. In the past, NSPS provided a \$2,000 scholarship to the national TrigStar winner. Because the winner didn’t always continue to a surveying degree, the scholarship was changed. NSPS now offers a \$5,000 scholarship to anyone who participates in the program and desires to become a Professional Surveyor. This year the Ohio TrigStar winner received the scholarship. He had applied before he learned that he was the Ohio winner.
- 7.4 The Program Committee accepted the offer from Cleveland to host the 2011 Conference. The committee should be formed by February 2009. The 2009 Conference Committee finalized their program. The 2008 Fall Seminar finally filled the TDB speaker slot, which already had 13 attendees registered for that event. They have 168 full registrants and had a goal of 175. The additional one-day registrants should close the gap.
- 7.48 Scholarships and correspondence were mailed.
- 7.49 The Scholarship Fund Board reported that the notice for donations with the dues returned results. They are looking toward forming a separate foundation, 501.c.3, able to accept tax-deductible donations.

#### Chapter Delegate Reports

The Central Ohio, Muskingum Valley, Northwest Ohio, Ohio Valley, Scioto Valley, Treaty lands, Tuscarawas Valley and all of the student Chapter Delegates were absent. All other Chapters submitted written reports.

- 9.0 Dean Frederick is accepting nominations for 2009 Officers and participated in the Vision Committee. Motion to adjourn: 9:46 p.m.

Respectfully submitted,

**John G. Hoy, P.S.**



Lorain County has new FEMA flood zone maps with an effective date of August 18, 2008. (see image example below)

Many, if not all, flood zone maps are available for free online viewing at this webpage: <http://msc.fema.gov/webapp/wcs/stores/servlet/FemaWelcomeView?storeId=10001&catalogId=10001&langId=-1> Maps can be pulled up by Map Panel ID or by street address. See FEMA webpage screen capture below left.



Do you have a stack of old FIRM maps in your files? The next time you need to use them, you should check online to see if there is an updated map online first. The maps are free to view online and to make an 11x17 print (using Make FIRMette button), and you can purchase a map image file and download the full



size image to print or incorporate into your drawings.

Their website is a little slow and temperamental, so have patience. If you have questions about this FEMA webpage, feel free to contact me.

Robert Hoy  
CSN Editor

# Jake's Stakes

# AMISH MADE

7370 Camp Road Homerville, Ohio

# SURVEYING and CONSTRUCTION STAKES

**High quality, light colored, HARDWOOD and smooth**

## MARKER STAKES

18" x 1 5/8" x 1/2"	\$0.17 ea
24" x 1 5/8" x 1/2"	\$0.20 ea
30" x 1 5/8" x 1/2"	\$0.25 ea
36" x 1 1/2" x 7/16"	\$0.28 ea
48" x 1 1/2" x 7/16"	\$0.36 ea
48" x 7/8" x 1/2"	\$0.24 ea

## SQUARE HUBS

12" x 2" x 2"	\$0.24 ea
18" x 2" x 2"	\$0.32 ea
22" x 2" x 2"	\$0.36 ea

## WEDGES HUBS

22"	HUB MARKER	\$0.13 ea/Bundle of 100
9"		\$0.13 ea
12"		\$0.15 ea

## METAL REBAR RODS

**30" x 5/8" \$1.48 ea 20 per bundle**

■ **NO ORDER TOO**  
■ **SMALL or TOO**  
■ **FAR**  
■ LARGE INVENTORY

**ORDERS FILLED  
RAPIDLY!**

FREE DELIVERY ON  
LARGE ORDERS



***IF WE DON'T HAVE IT - WE MAKE IT!***

DELIVERY AVAILABLE : CALL Dwight at Spencer Feed & Supply 330-648-2111

\* WE DELIVER ANYWHERE \* WE DELIVER ANYWHERE \* WE DELIVER ANYWHERE \*

## Have You Ever Seen a Column Line Move? By John G. Hoy, P.S.

I've used Architectural and Engineering plans for construction layout for over thirty years now. I can remember when most all buildings followed a nice rectangular shape since that was the easiest to build. But everything changes. Now, if you want a building and site design to be unique, rectangular shapes are boring. In their quest for the unusual I've seen designers using concentric circular walls, multi-faceted roof pitches, pyramid atriums, adjoining-connecting trapezoidal rooms and wings extending at every angle of a protractor. I've even handled calls from construction superintendents asking the length of a wall that was described on the plans as being a section of curve with a 2.5° delta angle. I had the answer but I couldn't tell him why it was designed that way.

The down side to this trend is the necessity of a very complicated structural plan. To accommodate radial patterns of columns or staggering roof piers designers use intermediate designations such as **3.7** or **A.4**. This is a workable method of highlighting that a column or set of columns is intentionally out of order with the regular overall pattern of support within a design. It is also just as important to convey that critical information to the team constructing the project on the ground. After all, that is where you don't want to see a mistake. Or you would think!

One of my recent projects is what will be a beautiful theater building designed by a very well known Cleveland firm. The column designations across the building are 1, 2, 2.5, 2.9, 3, 3.7, 4, 4.5, 4.6, 4.9, 5, 5.4, 5.5, 6, 6.5, 6.6, 7, 7.1, 7.4, 7.5, 8, 8.3, 9, 9.1 and 11 (skipping 10 entirely). In the perpendicular direction A, B, C, D, E, F, F.7, G, G.2, H, J, K, K.6, L, L.3, L.4, L.6, M, M.1 and N. Obviously, these designers are comfortable with using intermediate designations. Following another trend, the column designations shown on the North and South or the East and West sides of the building plan did not list every column on both sides. Even some overall dimensions were omitted. The plan was a little less crowded with numbers and maybe that was their intent.

My surprise came two weeks into construction. I was standing inside the building surrounded by perimeter walls fast approaching three feet high staring at a column we just checked into that didn't agree with my calculated location. A few additional minutes on the plans and I noticed a discrepancy with the location of Column 3 from one side to the other side of the building. When I questioned this with the superintendent he quickly said, "That's right. It jogs over five inches inside the building." All I could say was, "You **are** kidding aren't you?" But there it was, drawn overlapping the lockers in a dressing room. Almost hidden.

As difficult as it was for me to wrap my brain around this new design concept I quickly found out that as of that moment in time; I knew, the superintendent knew, the company fabricating the steel knew and the designers knew. Just as no one had thought to mention it to me, they also neglected to tell the foundation/masonry crews.

What a recipe for disaster. In this situation, Column 3 happens to be located alongside the west wing of the building. The first construction plan was to start in that wing. Luckily, an overhead power line was delayed in being relocated causing construction to begin on the East side of the building. *A major problem, and certainly major lawsuits, averted by random chance.* That morning, we set two points inside the building right where the jog was drawn on the plans and revised our stakes to read Column 3 North and Column 3 South. As stupid as that may sound.

Incidentally, Columns 5.4 and 5.5 are only two inches apart and so are Columns 6.5 and 6.6. Believe it or not, elsewhere in the same wing there are three columns intentionally offset 2-5/8" from the nearest column line on the plan. Could this level of consistency in design be the next design trend? Are detailed plans like a box of chocolate? You never know just what you're goanna get? Watch out!

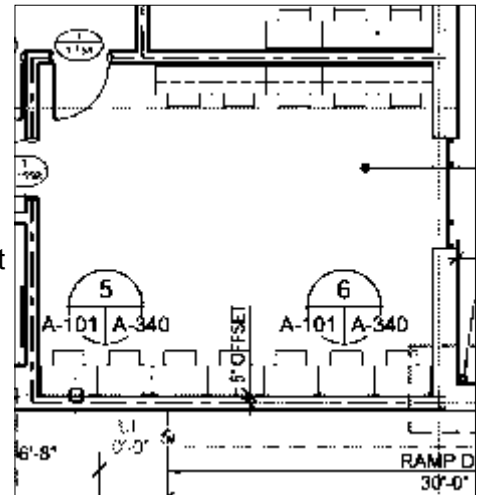

## State PLSO Website Upgrade

The State PLSO website, [www.ohiosurveyor.org](http://www.ohiosurveyor.org), has added a **Members Only** button on the left side of its page. Your **User ID** will be your PLSO Membership number which can be found on your dues invoice that you recently received. Your **Password** will be the last 4 digits of your phone number on file with State PLSO. If you have trouble logging in your first time, contact Barb Jones. Her information is available on the *Contact Us* page of the State PLSO website.



**Robert Hoy**

Communication  
Trustee

Once successfully logged in, you can view member listings by chapter, membership category, or alphabetically as well as searching for someone's name. There is also a section inside for announcements for members only.

I was pleasantly surprised to see the [\*Ohio Surveying News, Issue 2, 2008 is now online\*](#) in the Downloads section of Members Only. It is downloadable in a large 10MB PDF file of which some photographs and graphics are in color. It also has some in-document hyperlinks as this PDF has. I'm glad to see the State PLSO office and executive committee taking notice of what the Cleveland Chapter has been doing for nearly 2 years with our online-only *Cleveland Surveying News*. I really hope the PLSO membership will be given the choice to stop receiving the *Ohio Surveying News* in print form choosing online/PDF reading instead.

The Members Only section is an effort to update the way PLSO communicates with its members. I strongly encourage everyone to log into the Members section to check and update your contact information on-file especially your email address.

## Surveying Resource WebPages

[www.clevelandmemory.org](http://www.clevelandmemory.org) - historical photographs of the Cleveland area.

[www.railsandtrails.com](http://www.railsandtrails.com) - scans of very useful old township, USGS, railroad, etc. maps.

<http://benchmarks.scaredycatfilms.com/OH.html> - NGS benchmark database with Google Map interface

<http://msc.fema.gov/webapp/wcs/stores/servlet/FemaWelcomeView?storeId=10001&catalogId=10001&langId=-1>

- online FEMA FIRMS (Flood Insurance Rate Map)

<http://gis.cuyahogacounty.us/> - Cuyahoga County GIS (still under construction but viewable)

<http://ohiodnr.com/water/oeplats/tabid/3300/Default.aspx> - scans of canal maps in Ohio

**Reminder:** all [blue](#) underlined text in this issue is a hyperlink to a webpage, an email address, or to another page within this PDF document. And the [Cleveland Surveying News - September 2008](#) is a link to the Contents page.

## November CPD Seminar Dinner Meeting

**Nov 6** Carl Gedeon and Grace Ann Kramer of SCORE (Service Corp. of Retired Executives also affiliated with the U.S. Small Business Administration) and Bob Fenn from P.T.A.C. (U.S. Procurement Technical Assistance Center at Lake Erie College) will present our third Fall 2008 educational seminar entitled:

Topic: "Enhancing Business Skills" 1.5 CPD Hours

- General business advice in a tough economy
- How to prepare a business plan, and what it is used for
- Negotiation and marketing techniques
- Working with the government
- Improving our self image as a profession

### Price



Members	\$35.00
Non-Members	\$60.00



## Meet the Newest Member of the Leica System 1200 Family



Here is what the  means:

-  Greater range of reflectorless EDM — up to 3,280 feet
-  Accuracy to reflectors  $\pm 1 \text{ mm} + 2 \text{ ppm}$  up to 9,840 feet
-  High-resolution color display
-  Faster lock features

### Introducing Leica TPS1200+, the fastest one-person total station in the world

Leica TPS1200+ is, without a doubt, the most comprehensive, everyday-use instrument available in the market. Whether you're doing land surveying, bridge monitoring, or construction, the performance provides your team with a big plus. This new family member pulls its own weight in every configuration. Robotic and manual versions guarantee you have the right tool for your job.

Take one out for a spin with your local Leica Geosystems representative today, or visit us online at [www.leica.com/bigplus](http://www.leica.com/bigplus) to view ALL the specs.

People you trust ■ Products you rely on ■ Service you count on

Visit [www.leica.com/bigplus](http://www.leica.com/bigplus)  
or call 1-800-367-9453 for more information

William Helmick • Leica Geosystems Inc. • 440-350-1347

- when it has to be **right**

**Leica**  
Geosystems

## 2008 Cleveland Chapter Calendar

October 2                    **Seminar Meeting**  
 October 9-10            **PLSO Fall Seminar, Kings Island**  
 October 17                State Executive Committee Meeting  
 October 20                **Executive Committee Meeting**  
 October 24                Cleveland Surveying News Deadline

November 6                **Seminar Meeting**  
 November 10            **Fall Technician Workshop**  
 November 14             State Executive Committee Meeting  
 November 17             **Executive Committee Meeting**

December 4                Cleveland Surveying News Deadline  
 December 12             State Executive Committee Meeting (if needed)  
 December 15             **Executive Committee Meeting** (if needed)

January 9, 2008           State Executive Committee Meeting  
 January 12, 2008        **Executive Committee Meeting**  
 January 13, 2008        Cleveland Surveying News Deadline  
 January 22, 2008        **Annual Meeting**

### Executive Committee Meetings

are held at the office of :

John R. Hoy and Associates  
 4562 W. 130 St., Cleveland

at 6pm and are open to all members  
 of the Chapter who want to attend.

### **September 4<sup>th</sup> CPD Dinner Seminar Review    by Peter D. Zwick**

Nineteen of our members walked away from the seminar by Eric Pempus, A.I.A. with some good advice: If you aren't already using written contracts, then use one like the sample one-page document suggested by his employer, Selvaggio, Teske & Associates, which was distributed free of charge to all attendees.

Speaking of "free of charge," our seminars continue to be offered to our members at about the cost of the meal and accommodations at the Airport Marriott Hotel. Therefore, you receive the C.P.D. hours for as close to "free" as you can get. Attendees received a certificate for 1.5 P.D.H.'s this time around (which is 50% more free, on top of the first free hour that we usually award!). Get the picture?

Yes, Selvaggio, Teske & Associates sells professional liability insurance to surveyors, engineers and architects (but not for free). In fact, they already underwrite a significant percentage of the firms represented at the seminar.

Did you know that most claims against professionals arise because of poor communication? Usually it's our client doing the suing. Some more advice: get it in writing, and don't forget to also put it in writing on your end. Be sure to explain what your services are (and what they do not include). Check your proposals and brochures for the dreaded "Highest Standard of Care" citation, or "We're the Best" claims (because these are written communications which may come back to bite you later). On the public sector side, the same goes for RFQ's.

Eric is also a skilled construction dispute arbitrator, but he pointed out the merits (speed and economy) of the mediation technique for dispute resolution. Regarding B.I.M., he feels that it won't become prevalent anytime soon, even though it is now creeping into large mega-construction projects. There were several comments and questions from the audience regarding the pitfalls of electronic dissemination of digital work products (be careful when e-mailing your drawings). What ever you do, don't do what the hapless surveyor in Eric's case study did!

Chicken Marsala will be the menu selection for October 2<sup>nd</sup> seminar, by the way. See you there.



Speaker Eric Pempus, A.I.A.

Meeting highlights from 09/15/08, office of John R. Hoy & Associates:

"As our Ex Comm meeting was held the Monday after the remnants of Hurricane Ike rolled through town, several members of the committee were unable to attend as they dealt with power-outage issues.

George Hoffman was welcomed back to the Executive Committee, this time as the new Program Trustee. Nominees for next year's committee will be formulated by October 15.

Bob Hoy announced there will be a Chapter Newsletter published in December to replace the February issue.

Pete Zwick mentioned that Kathleen McGervey, who recently lost her brother Joe, attended the Republican National Convention in Minneapolis last month.



**Michael A. Straub**  
Secretary

**This is an invitation to join a new organization known as:**

## SECRET SOCIETY OF SENIOR SURVEYORS (S<sup>4</sup>)

Definitions:

Why Secret:	No Reason, Just adds another "S"
Society:	Group, Club, Whatever.
Senior:	Sixtyish. Being retired is not a requirement.
Surveyors:	If you do not know by now, it is way too late anyway. Those who have practiced, worked or played in the profession of Land Surveying or related endeavors.
Professional Affiliation:	PLSO, ACSM, OSPE or <b>NONE</b> .
Meetings:	Lunch at Sokolowski's University Inn 1201 University Road, Cleveland, Ohio
Cost:	Your Meal
When:	The Third Tuesday of the Month, 12:30 P.M.
Agenda:	Exchange War Stories, Tell Tall Tales, Bemoan Current State of Surveying, Share Insight and Knowledge, General B.S.
Rules:	No Dues, No Membership But Shirt and Shoes Are Required.
Who:	Whoever Can Make It. No Reservations.

**Come out and enjoy.**

For more information, call John Dailey 440-888-1930 or Jack Hoy 440-877-1434



## 4733-37-05 Plat of survey

(A) The surveyor shall prepare a scale drawing of every individual survey, or drawings comprising all of the surveys when they are contiguous, in which the surveyor retraces previously established property lines or establishes new boundaries.

(B) A copy of this drawing shall be given to the client. When required, another copy shall be filed with the appropriate public agencies.

(C) The surveyor shall include the following details:

(1) A title such that the general location of the survey can be identified. The title shall include, but not be limited to: state, county, civil township or municipality, and original land subdivision description.

(2) A north arrow with a clear statement as to the basis of the reference direction used. **If the reference direction used is to a geodetic datum, add a clear statement of the measurement method and Control Station(s) used to reference the datum, the date of the measurements and the adjustment version of the datum, if applicable.**

(3) The control station(s) or line(s) cited in the description and the relationship of the property to this control must be referenced to an established monumented point of beginning such as, but not limited to: centerline intersection of streets or highways record, section or quarter section corners, Virginia military survey corners or lines, or platted lot corners. The type of monuments set or found **and used** at the control stations shall be noted **along with descriptive information as required for boundary monuments in 4733-37-05-C-4. Clearly indicate or describe the relationship of any evidence or witness monuments found and used as the basis for setting or re-setting any control station(s) for establishing all controlling line(s). There SHALL be enough references, notations and/or descriptive information about the monumentation and/or evidence found and used as the basis of the control station(s) and line(s) that if a future surveyor can find the same monumentation and evidence, that surveyor can reproduce the survey without using any of the set monuments. Additionally, clearly indicate the relationship of any other survey monuments or markers or possible survey markers found that were not used as a basis of the control station(s) or Line(s).**

(4) A notation at each corner of the property stating that the boundary monument specified in the deed description was found, or that a boundary monument was set, or a legend of the symbols used to identify monumentation. In addition, there shall be a statement describing the **size, material, condition, if not considered to be as originally set or normal, and size any markings or cap stamping** of every monument found or set **if it cannot be clearly indicated in the legend of symbols.**



- (5) A general notation describing the evidence of occupation that may be found along every boundary line or occupation line.
- (6) The length and direction of each line as specified in the description of the property or as determined in the actual survey if this differs from what is stated in the deed description by more than the tolerance specified in paragraph (B) of rule 4733-37-04 of the Administrative Code. The length and direction shall be stated as follows:
- (a) Bearings expressed in degrees, minutes and seconds and distances expressed in feet and decimal parts thereof on each course. If a metric equivalent distance is stated, it shall be stated to the third decimal place.
  - (b) All curved lines shall indicate the radius, central angle, curve length, chord bearing and chord distance.
  - (c) Each course shall show other common lines such as centerline of roads, rivers, streams, section lines, quarter section lines, half section lines or other pertinent common lines of record.
- (7) A citation of pertinent documents and sources of data used as a basis for carrying out the work. The citation shall include, but not be limited to: current deeds as of the date of the survey, prior deeds or other documents of record, and available deeds of record for adjoining parcels along each boundary line of the survey. If the adjoining parcel is a recorded subdivision, only the subdivision name, recording information and lot numbers need to be shown.
- (8) The written and graphical scale of the drawing.
- (9) The date of the survey.
- (10) The surveyor's printed name and Ohio registration number, signature and seal (in a form which may clearly reproduce on any copies which may be made of the original drawing).
- (11) The area contained within the perimeter of the surveyed parcel.
- (12) All references to roads or railroads contiguous to the surveyed parcel shall use current names or names of record and applicable right of way widths, if available.
- (13) All references to rivers or streams shall use current names of record, if available.

## 4733-37-06 Descriptions

(A) When a surveyor is called upon to prepare a new description, either to replace an existing description which is inadequate or to create a new piece of property, said description shall include the following items:

- (1) Sufficient caption so that the property can be adequately identified.
- (2) A relationship between the property in question and clearly defined control station(s).
- (3) The basis of the bearings. **If the basis of bearings used is to a geodetic datum, add a clear statement of the measurement method and Control Station(s) used to reference the datum, the date of the**

**measurements and the adjustment version of the datum, if applicable.**

- (4) A citation to the public record of the appropriate prior deed(s).
- (5) The surveyor's name, Ohio registration number and date of writing and/or survey.
- (B) A metes and bounds description shall include, in addition to paragraph (A) of this rule:
  - (1) A description of the boundary monument used as the initial point of the description.
  - (2) A series of calls for successive lines bounding the parcel, each of which specifies:
    - (a) The intent in regards to adjoiners or other existing features.
    - (b) The direction of the line relative to the direction of the basis of bearing.
    - (c) The length of the line.
    - (d) A description of the boundary monument (or reference monument) **SHALL include size, material, condition, if not considered to be as originally set or normal, and any markings or cap stamping** and whether found or set to identify the end of the particular line. **An abbreviated description may be used in the courses of the description if a detailed monument description statement is made at the end of the description.**
    - (e) All curved lines shall indicate the radius, central angle, curve length, chord bearing, chord length and direction of the curve.
    - (f) The reported boundary data shall meet the closure requirements of paragraph (C) of rule 4733-37-04 of the Administrative Code.
- (3) The area of the parcel.
- (C) Descriptions other than metes and bounds descriptions may be a reference to a recorded survey plat or a parcel on a recorded survey plat and shall include sufficient and adequate legal and technical wording so that the property can be definitely located and defined.
- (D) A statement shall appear indicating that either: the description was made in accordance with a recent survey and the date thereof, or the description was made based on a previous survey, of a certain date, and date of description, or the description was not based on a survey.
- (E) When the surveyor knows a new description is to be used for a fee transfer, the surveyor shall base the description on a current or updated survey of the property **and include a statement making reference to the survey and to the Plat of Survey as required in 4733-37-05-A and 4733-37-05-B, if applicable.**



### **PLSO "Visions" Committee Report** 9-4-08 (draft)

This Committee was charged with creating a "vision" for the future path of PLSO. We began with a "wish list" of sorts as provided by Past President Brad Kramer, categorized it, added a few items and began to set a time frame as we saw fit. This plan, flexible as it may be, is intended to provide a guideline for the future day-to-day operations and long term planning of the organization, its officers, staff and committees, chapters and members.

#### **The Executive Director**, with the assistance of the Office Staff:

This individual needs to be hired as soon as possible. This organization is somewhat in limbo. This person shall be responsible for overseeing the daily operations of the office and its staff. This will include,

1. Run PLSO like a business to meet the goals of the organization as established by the Executive Committee (ExCom).
2. Hire, fire, train and discipline of staff members to make PLSO run more efficient.
3. Establish normal business hours and insuring that the office is staffed during those hours.
4. Oversee the expenditures to maintain the current budget as established by the Executive Committee.
5. Update office equipment/software to make the office as productive as possible.
6. Update insurance and tax reporting forms as needed.
7. Be responsible for accomplishing deadlines for events such as OSN publications, dues notices, seminar and conference registration mailings. For the PLSO to run properly, it is very important that these deadlines are met on time, every time.

#### **Communications:**

##### **Ohio Surveying News (OSN):**

1. A new Newsletter Editor needs to be put into place as soon as possible. This person needs to have a passion and understanding of the surveying profession in order to keep the news current and keep up with the ever changing industry and its challenges.
2. Publish the OSN on time, every time, with the most current news and information possible. Late issues are not beneficial to anyone. Are our sponsors getting their money's worth?
3. Modernize and update the format of the OSN.
4. Publish the minutes from the ExCom meetings, officer and committee reports, the yearly budget and articles from the chapters and members. This would help to let the membership know what it takes to run this organization.
5. Consider "publishing" the quarterly OSN via the website only. This would cut much of the cost of distributing the publication.

##### **PLSO Website:**

1. Update and modernize all facets of the current website. Some portions have been "under construction" for way too long.
2. Use the "Members Only" section to keep the membership directory current.
3. Add a smaller monthly issue of the OSN to keep issues or topics more current.
4. Add a "Committee" area to the member section for various committee to discuss their work/current charges and prepare reports.
5. Consider "Classified/want ads" for the members.
6. Consider an "Advertising" section to the public listing current members/companies at a small rate.

#### **Education:**

##### **Conferences/Seminars:**

1. Offer a wider variety of new programs and speakers. Many have stopped attending because they are hearing the "same old thing" from the "same old speakers".
2. Offer more professional courses to our more mature membership. Don't teach beneath their expertise. The future surveyors can always learn a few things they will need later in their careers.
3. Offer more affordable local seminars around the state. This could be accomplished more



efficiently on a chapter level. This would also eliminate the need for overnight stays when attending a seminar. Consider local talent for speakers.

4. Provide distance learning opportunities throughout the year. Colleges may be of some help in this endeavor.
5. Offer seminars to a wide range of professionals including, attorneys, realtors, etc. This would provide a means for opening doors and promoting understanding between professions.

#### Conference Committee:

1. Improve contract negotiations. With conferences/seminars increasing in size, we are getting limited to the facilities we can use.
2. Include ExCom, committee, and Past President meetings at the Annual Conference. Host a new delegate orientation. They may be more likely to participate if they had a better understanding of what is expected of them throughout the year.
3. Optimize interaction between attendees and the Exhibitors at the annual conference by staggering sessions and hosting special exhibitor events. This is vital to the sponsors in selling their product and critical to the members for enhancing their knowledge of new techniques and technology.
4. Provide discounted registration to key volunteers.
5. Use the new guidelines when planning and provide more timely reporting of the pertinent information.

#### Student Education:

1. Support the educational institutions, both financially, physically and morally. Hire our own graduates, keep the talent in Ohio. They are the future of this profession.
2. Mentor new surveyors and students. We all know they learn from experience, as much if not more than through the classroom. These tasks will need to be handled on the chapter/member level. For the survival of our profession, this is very important.
3. Participate in Career Days on all levels, from primary through high school children. Earlier contact is important. Most high school students are already on a path toward their future careers. Member participation is needed.
4. Promote the Trig\*star and Certified Survey Tech programs where possible. This is directed to the members as well as the chapters.

#### Scholarship:

PLSO should offer more scholarships, at higher dollar amounts, including those to non-traditional students, but with the current investment climate, the funds are being rapidly depleted.

1. Establish a separate "PLSO foundation" as a separate entity and fund it as needed. Set it up as a distinct 501(C)3 Corporation for tax purposes.
2. All funds should be kept separate from the PLSO general funds.
3. As a foundation, it may accept funds from a other sources, such as individuals, bequests, etc.
4. The foundation should have its own Board of Directors, Elections, and by-laws.

#### Legislation:

1. Maintain a healthy PAC fund. Solicit items for a PAC auction at the Annual conference. Every chapter needs to participate. Not just a few individuals. This is for the good of the society as a whole.
2. Develop a list of potential legislation to introduce, such as Statute of Limitations.
3. Establish a strong legislative action committee.
4. Develop a network of letter writing for pending legislation. We need members in key Senate and House districts to maintain contacts with our elected representatives.

#### Membership:

1. Promote membership to non-members.
2. Promote the PLSO reputation to members, non-members and the general public as "Professionals interested in improving and enhancing our profession".
3. Build strong relationship with adjoining states' societies, NSPS and other societies, such as the

Surveyor's Historic Society and Museum of Surveying. We need to all work together for the common good of the profession.

4. Get more involved with your chapter and the committees, both at the state and chapter level. Make a few suggestions for ways to improve the society.
5. Write an article for the OSN.
6. Talk at a career day for your children or their school.

**Future considerations:**

1. Revise the PLSO structure to include a Board of Directors, comprised of the Chapter Delegates. The new Executive Committee will consist of the Officers, the Executive Director and one member representing the Board of Directors. The new ExCom, will handle the normal operations of PLSO, such as approving new members. Since this would require opening the constitution again, this should wait until a later time.
2. Look into the possibilities of "virtual meetings" for the Ex Com meetings.
3. Group Liability Insurance. Promote ACSM/NSPS's program?
4. Group Health insurance
5. Group Workman's Comp
6. Legislation for Statute of Limitations, Standards for Easement Descriptions, County GIS being run by Prof Surveyors, Railroad Abandonment/Monumentation, etc.

While there is quite a bit to consider, this is intended to be a Vision for the future of PLSO. It needs to be revisited from time to time, updated, revised, new ideas added, and re-directed as the society and its goals change.

Rose M. Coors, P.S.  
Chair